

产品及模具相关的问题点小结

1. 机构问题

2. 粘模问题

3. 肉厚问题

4. 顶出问题

5. 加工问题

6. 强度问题

7. R角问题

8. 咬花问题

9. 抛光问题

10. 变形问题

1.1.1机构问题-简化机构

From



To

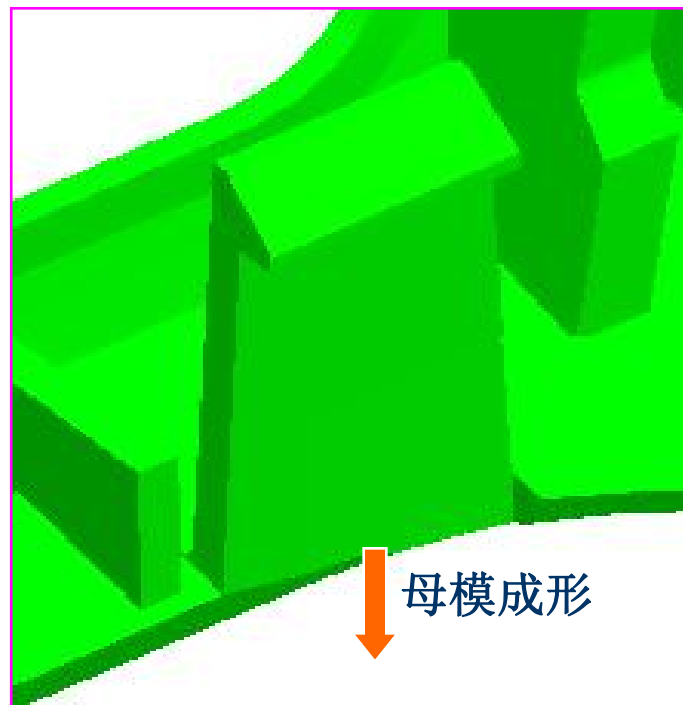
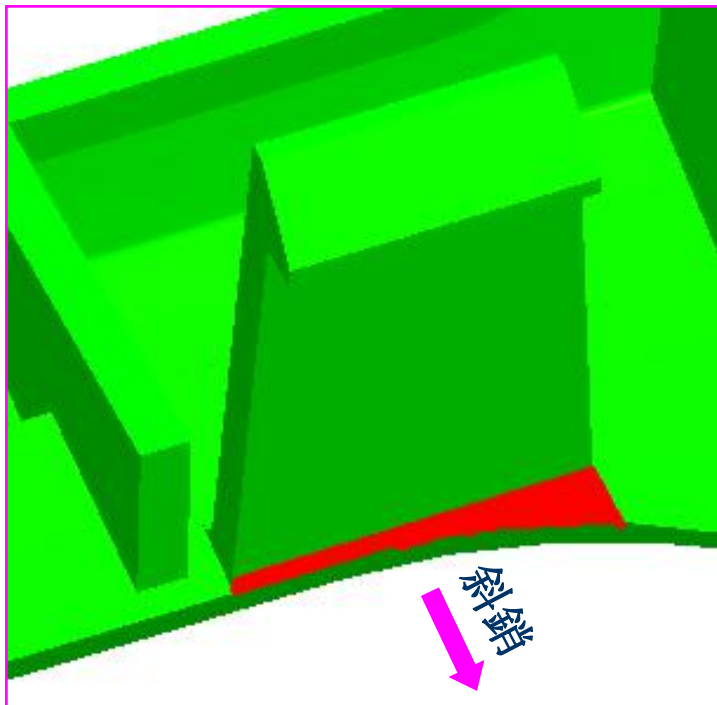

建议修改产品(是在不影响产品功能前提下).

1.1.2机构问题-简化机构

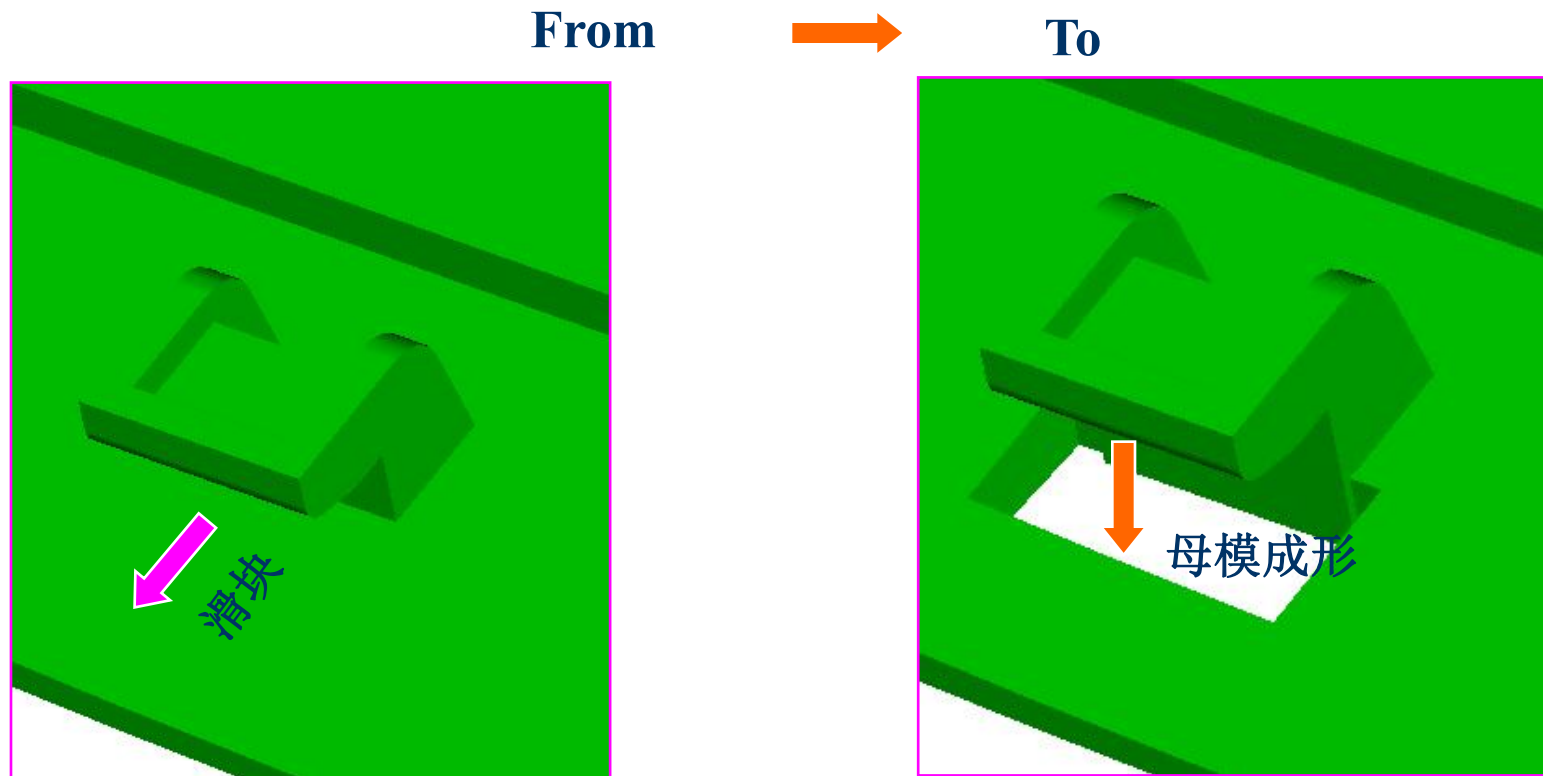

建议修改产品(是在不影响产品功能前提下).
修改之后可以简化模具结构.

1.1.3机构问题-简化机构

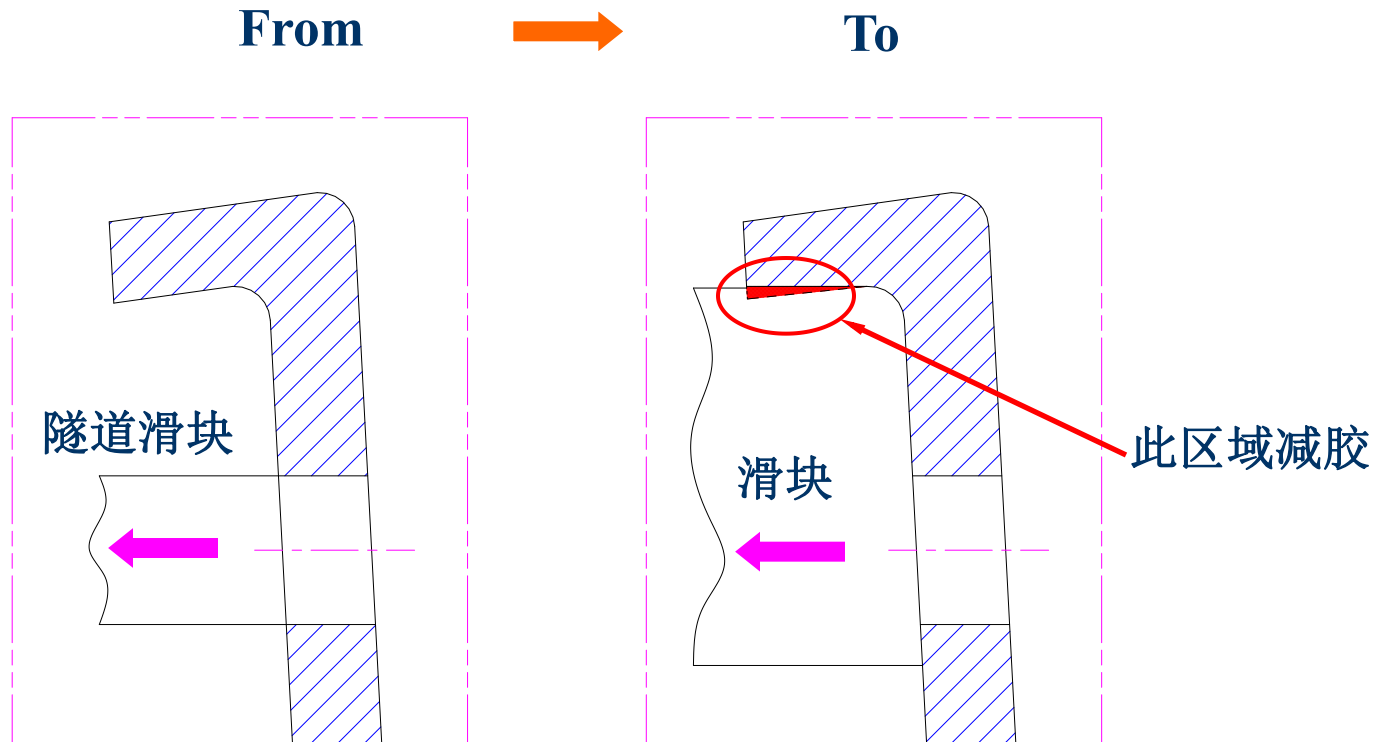

1.2.1 机构问题-行程不足

From



To

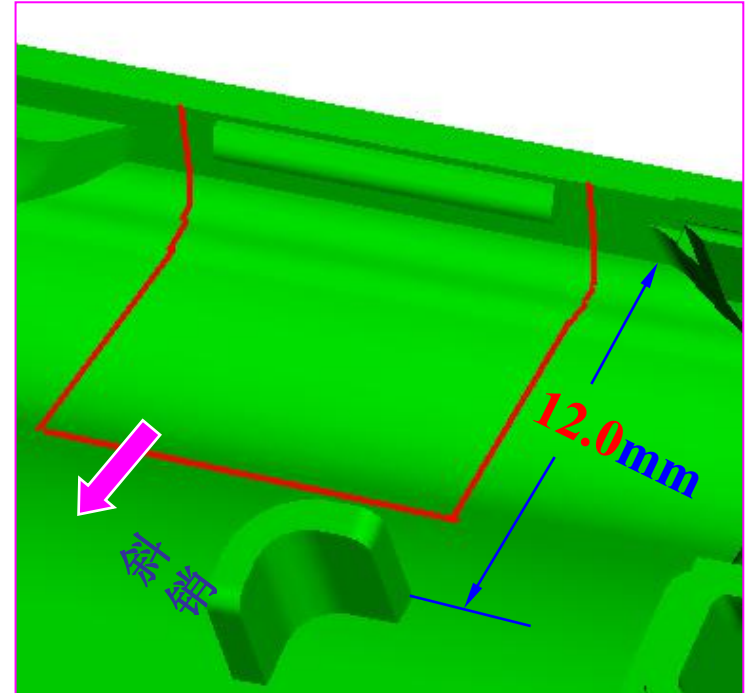
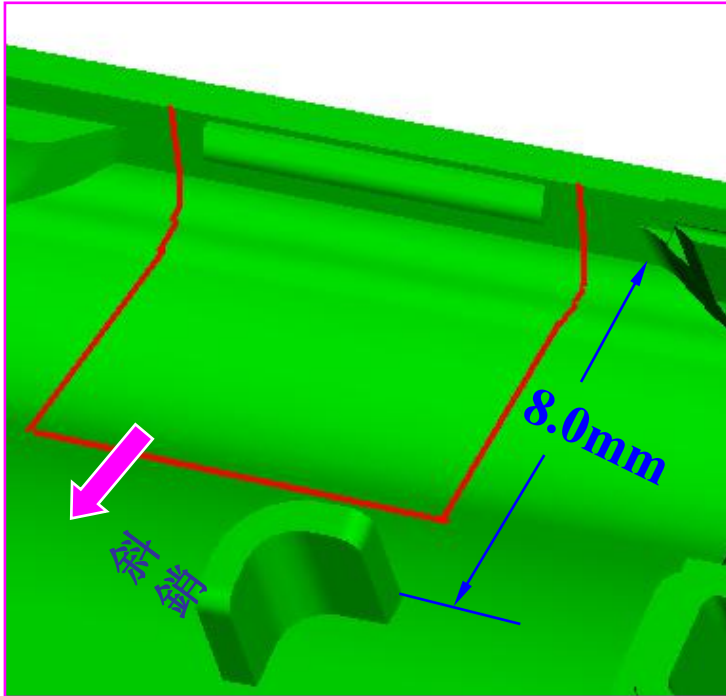

1.3.1 机构问题-无法脱模

无法脱模

From

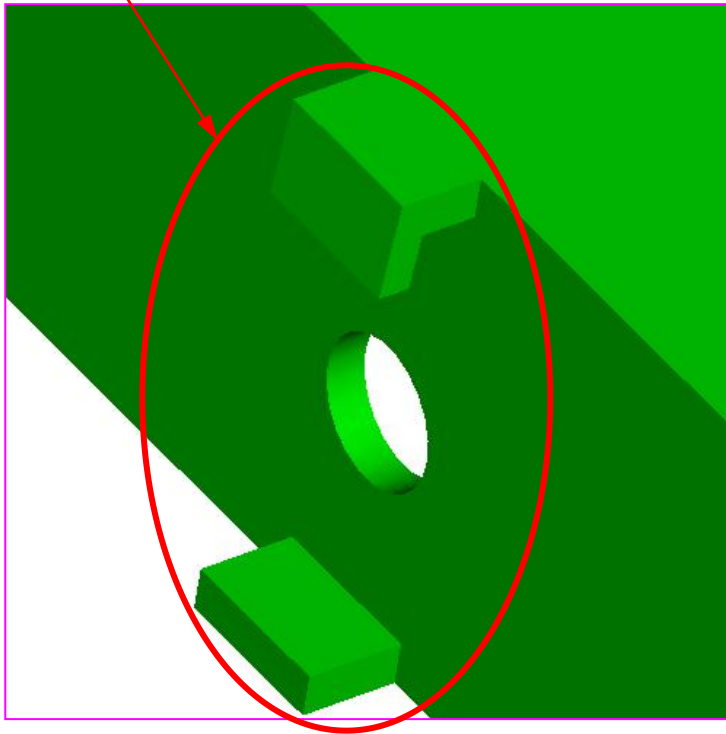

To

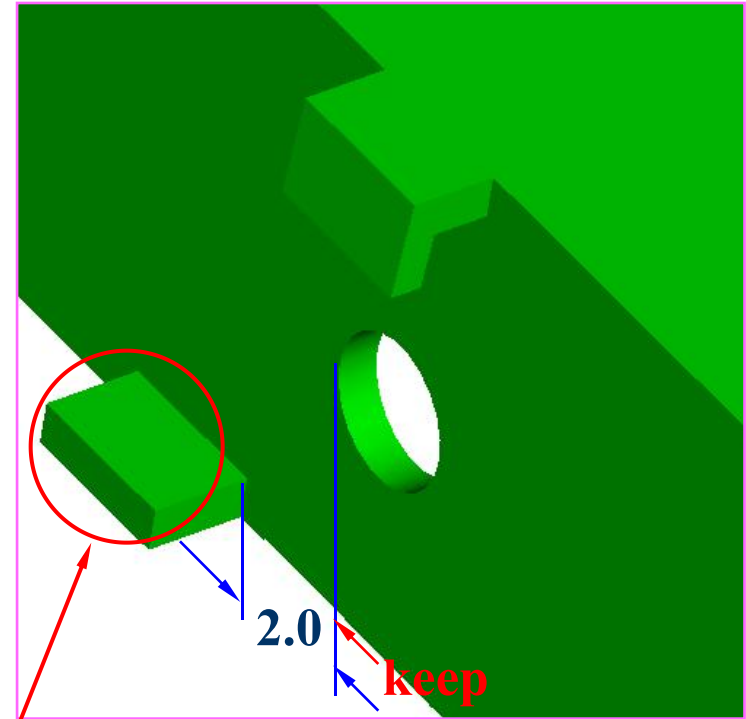

移动此特征

1.3.2机构问题-无法脱模

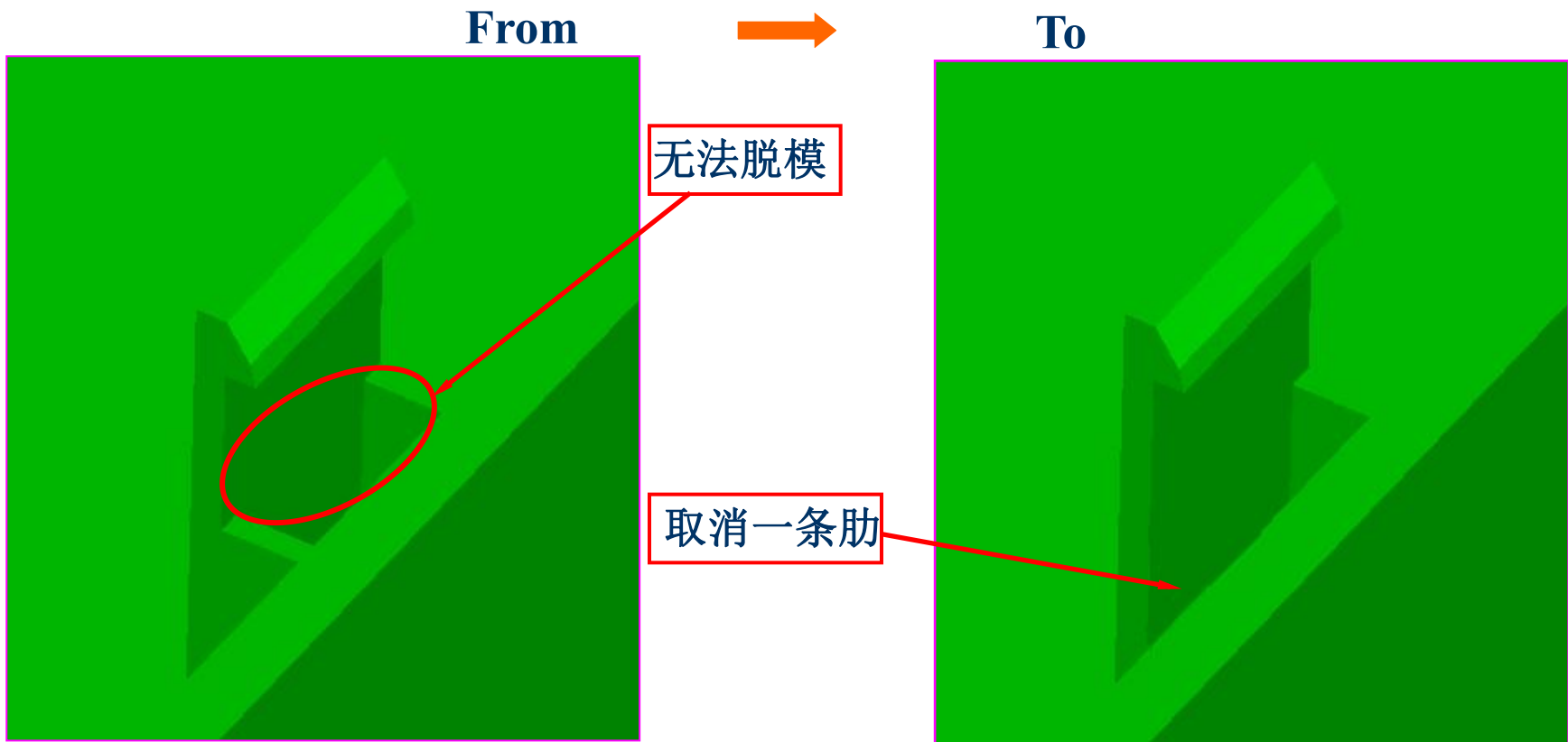

2.1.1 粘模问题-粘滑块

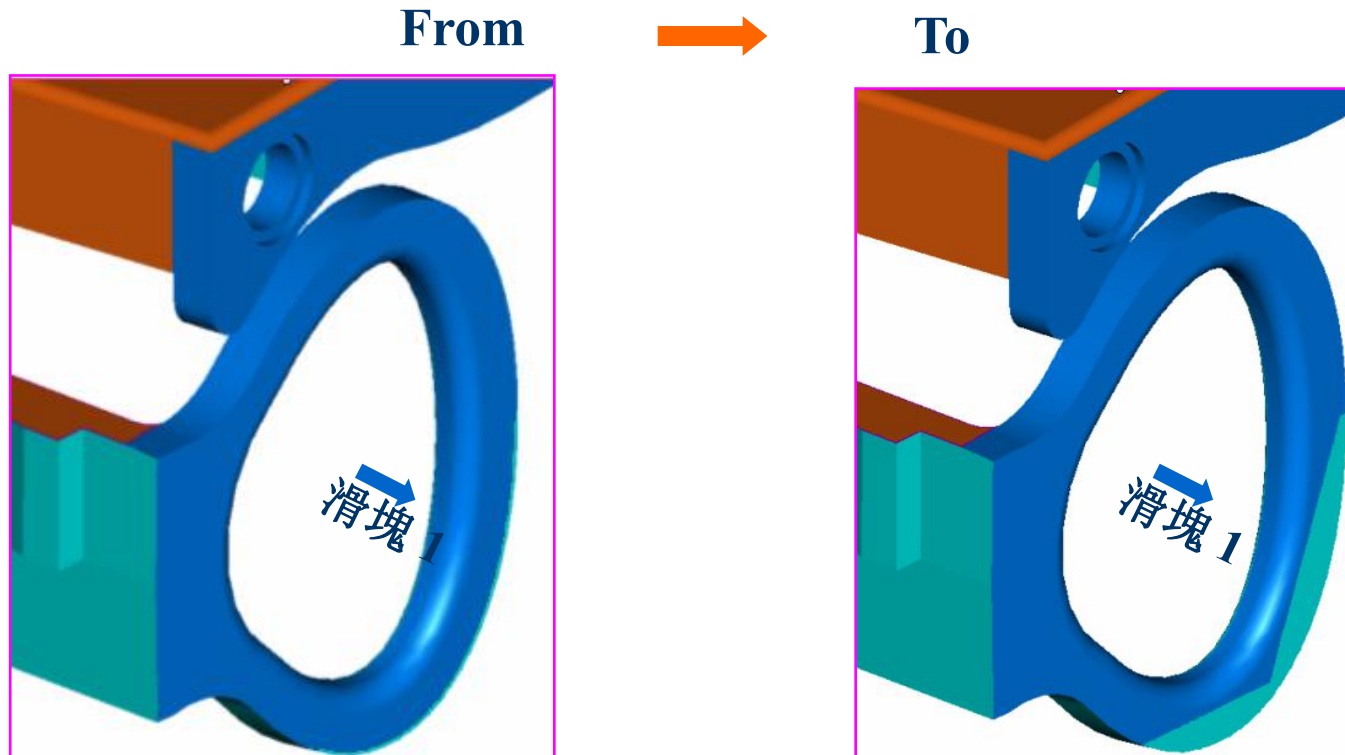

2.2.1 粘模问题-粘斜销

From



To

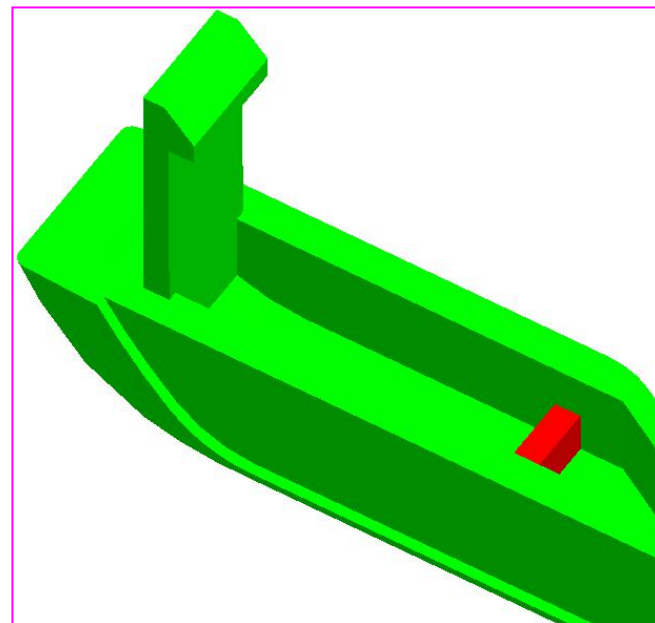
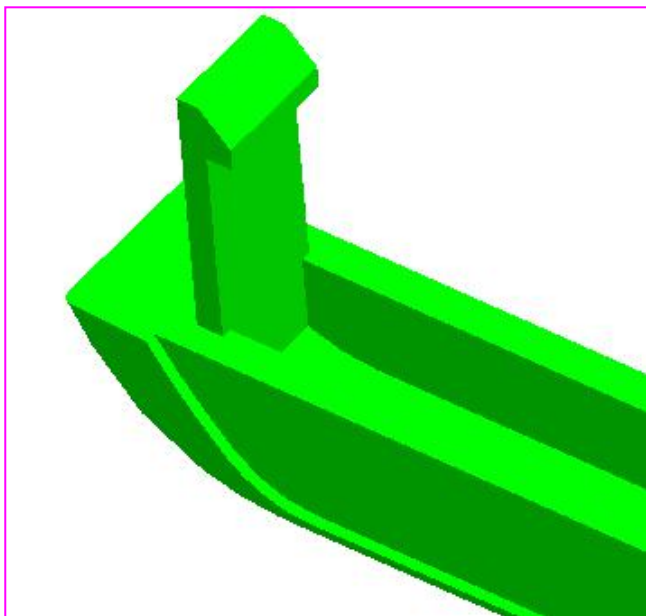

产品上加一条肋,在其右侧放一方销,以防止粘斜销(斜销被产品包住).

2.3.1粘模问题-粘公模

取消此红色肋

From



To

增加一条肋

以此为中间点

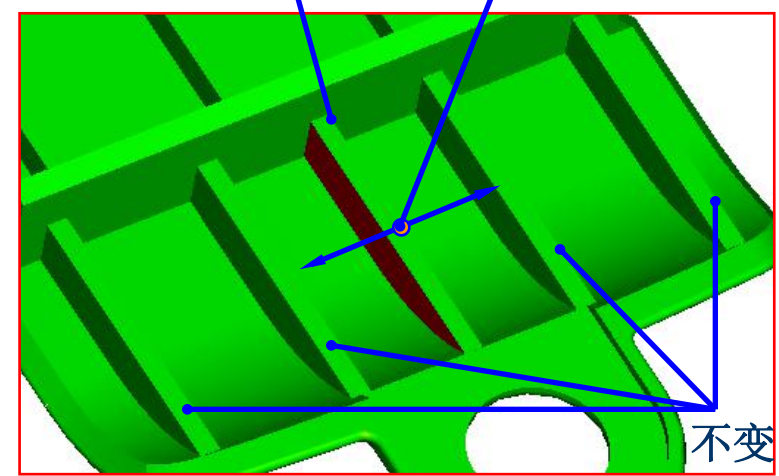
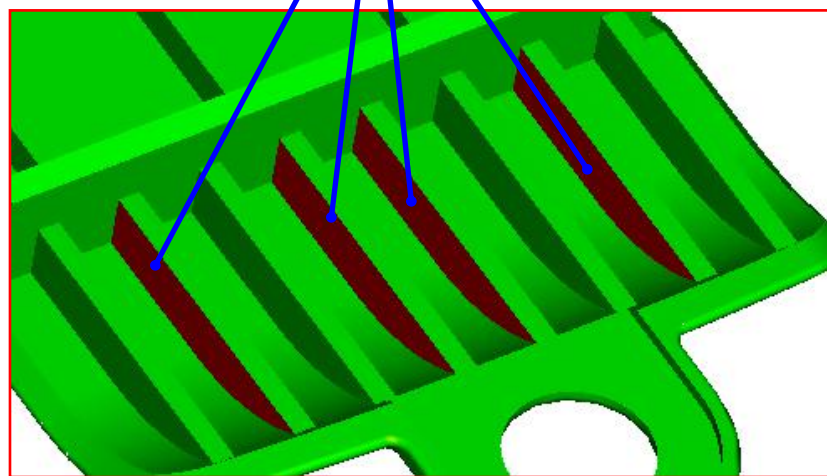

不变

3.1.1肉厚问题-缩水

From  To

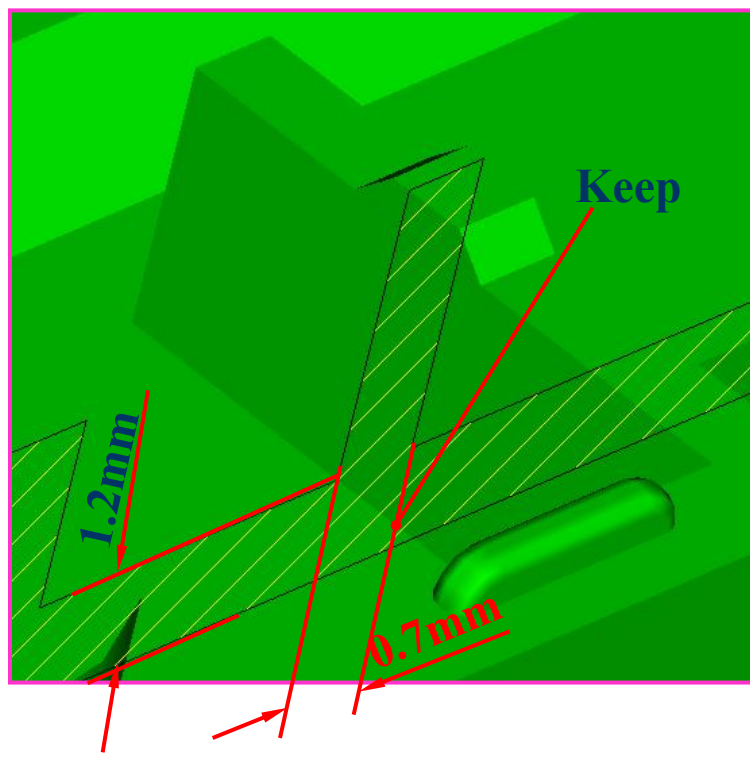
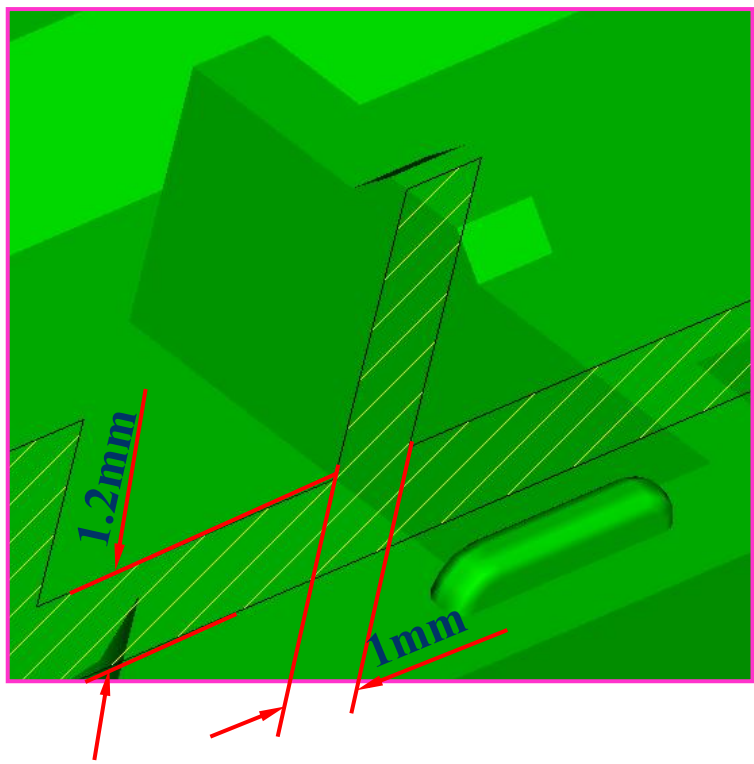

3.1.2肉厚问题-缩水

From  To

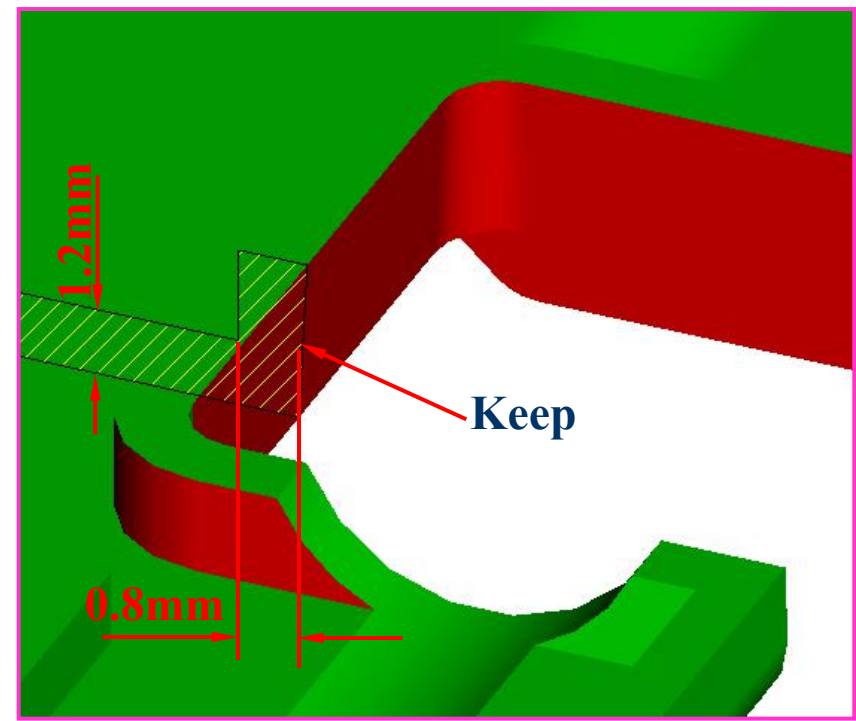
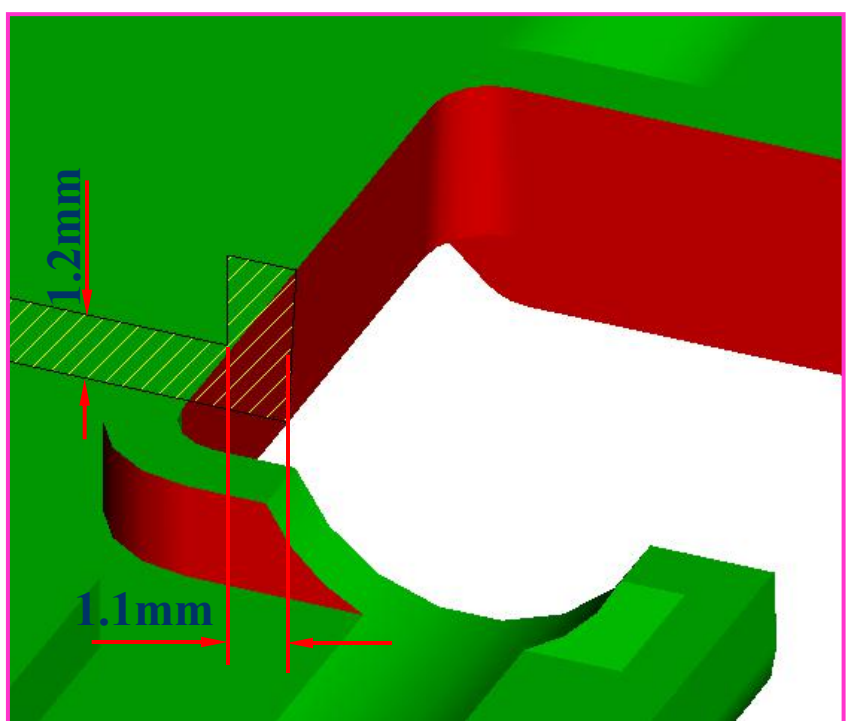

3.1.3肉厚问题-缩水

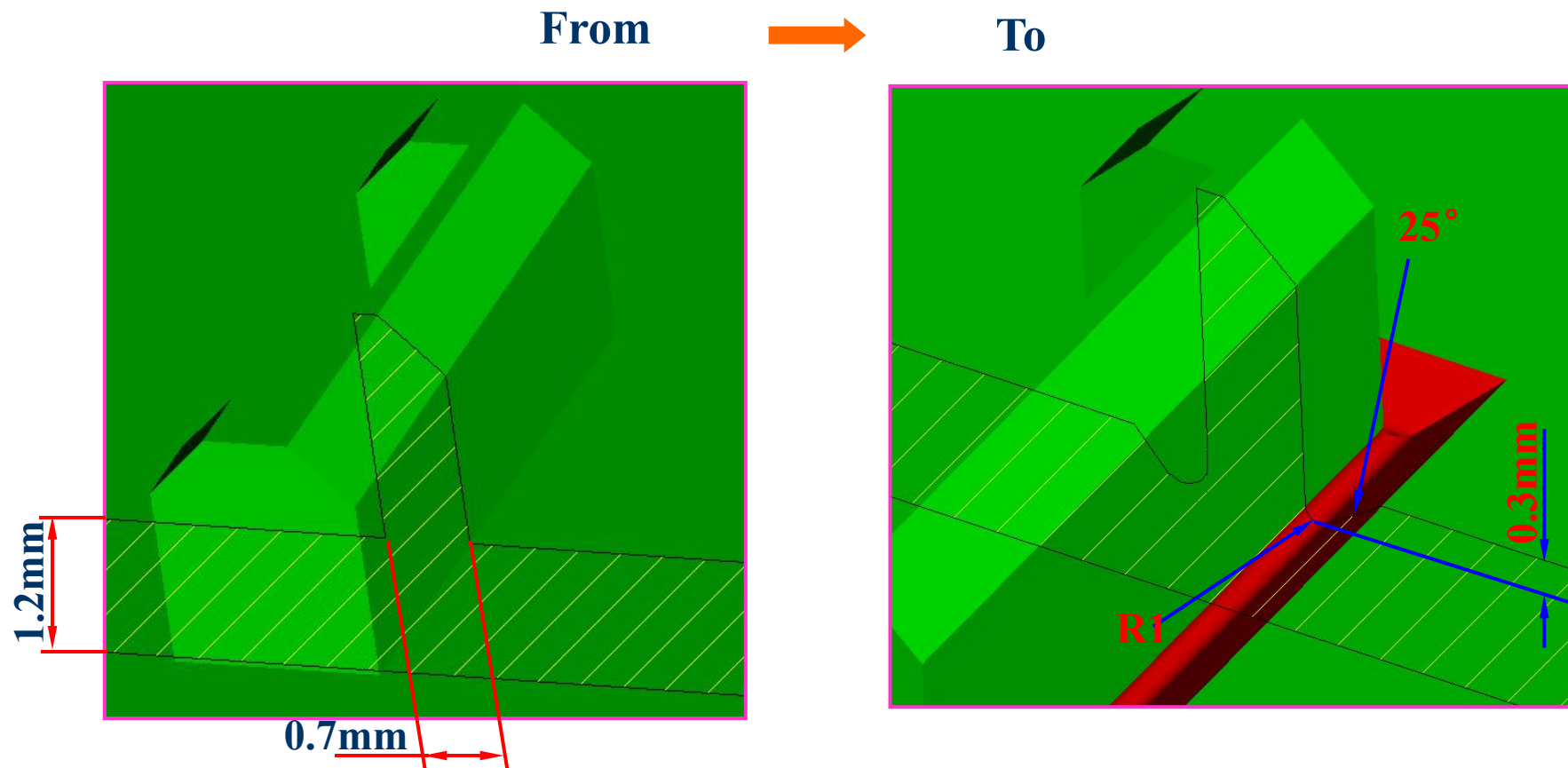

3.1.4肉厚问题-缩水

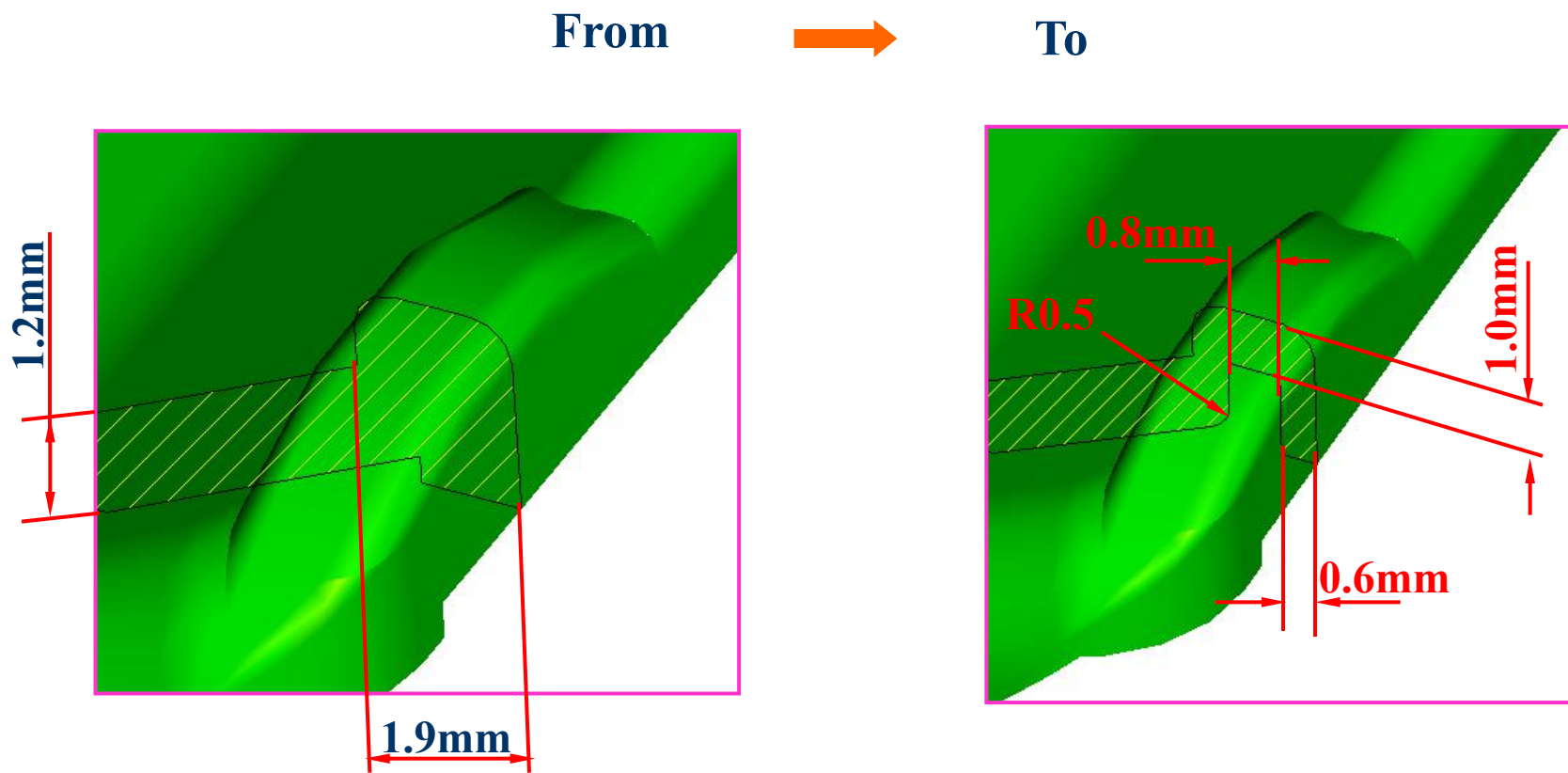

3.1.5肉厚问题-缩水

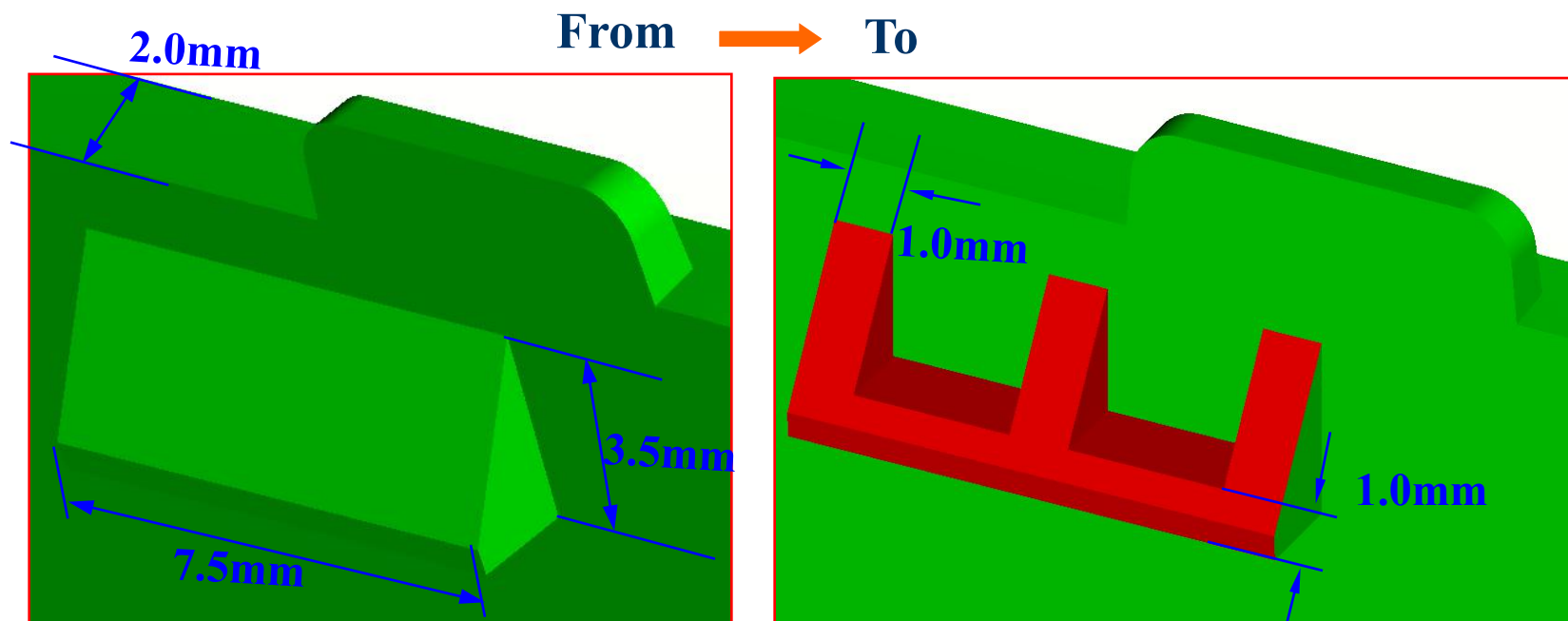

3.1.6肉厚问题-缩水

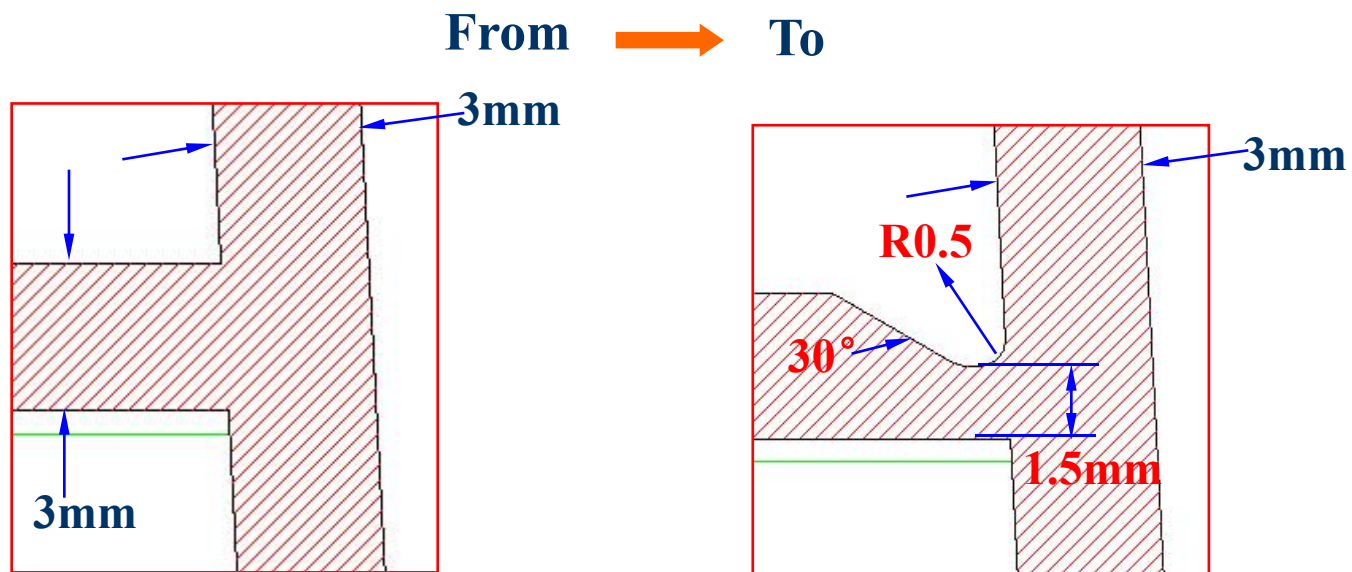

3.1.7肉厚问题-缩水

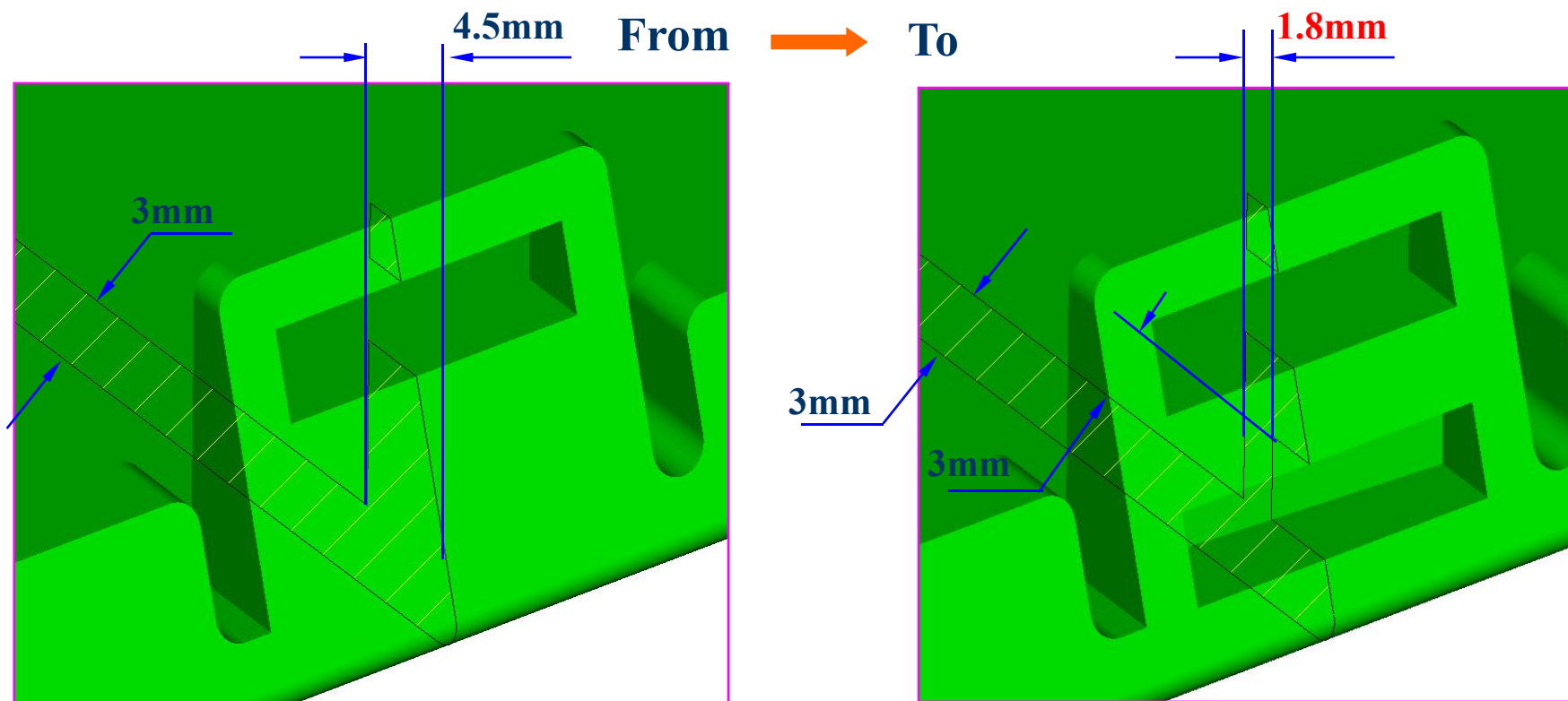

3.1.8肉厚问题-缩水

From → To

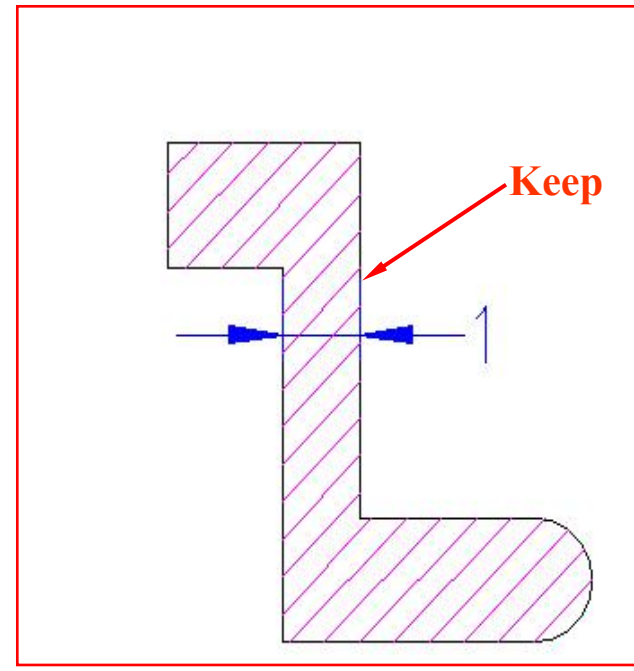
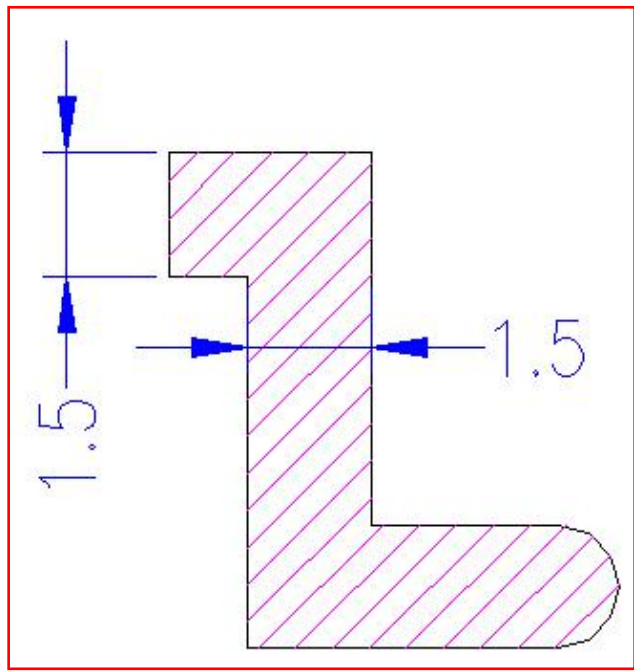

3.1.9肉厚问题-缩水

增加四条加强肋

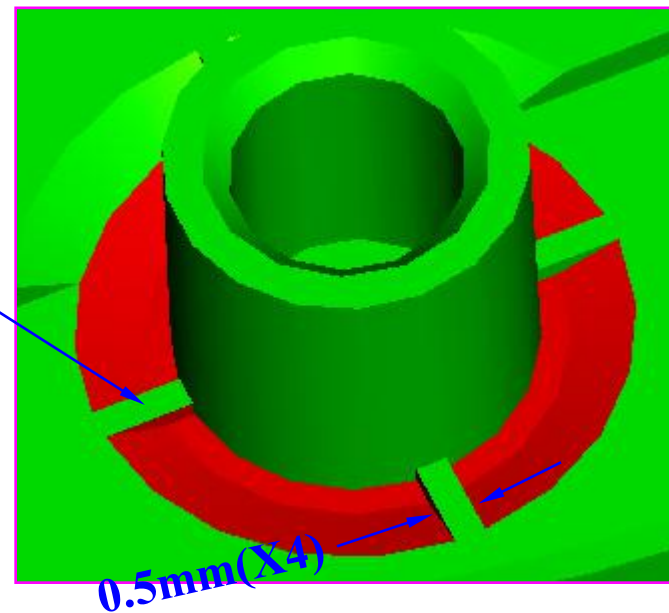

From → To

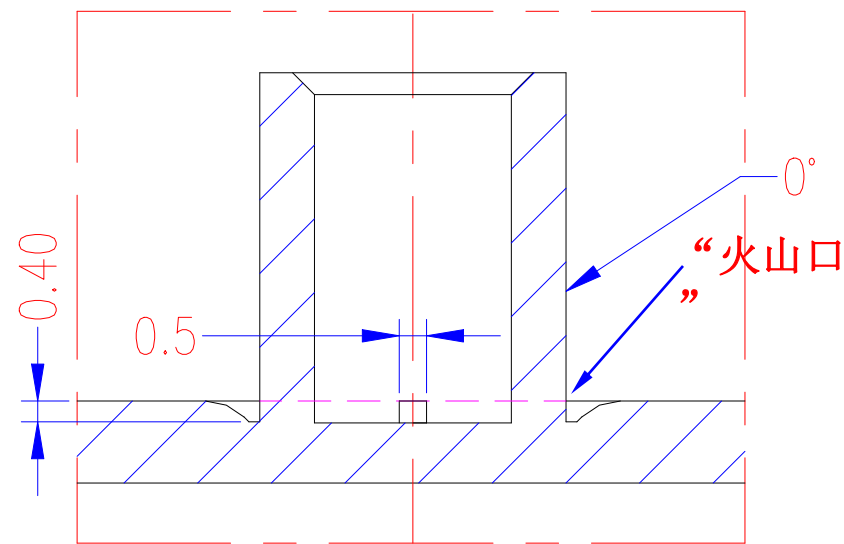
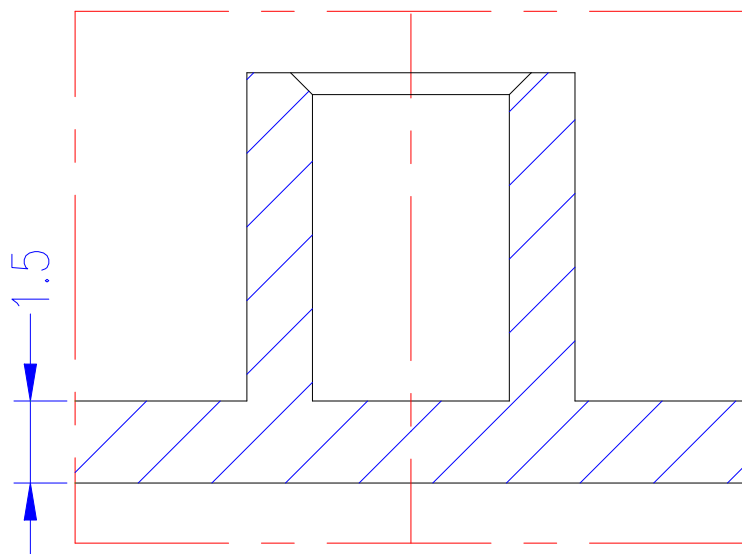

3.2.1 肉厚问题-阴影

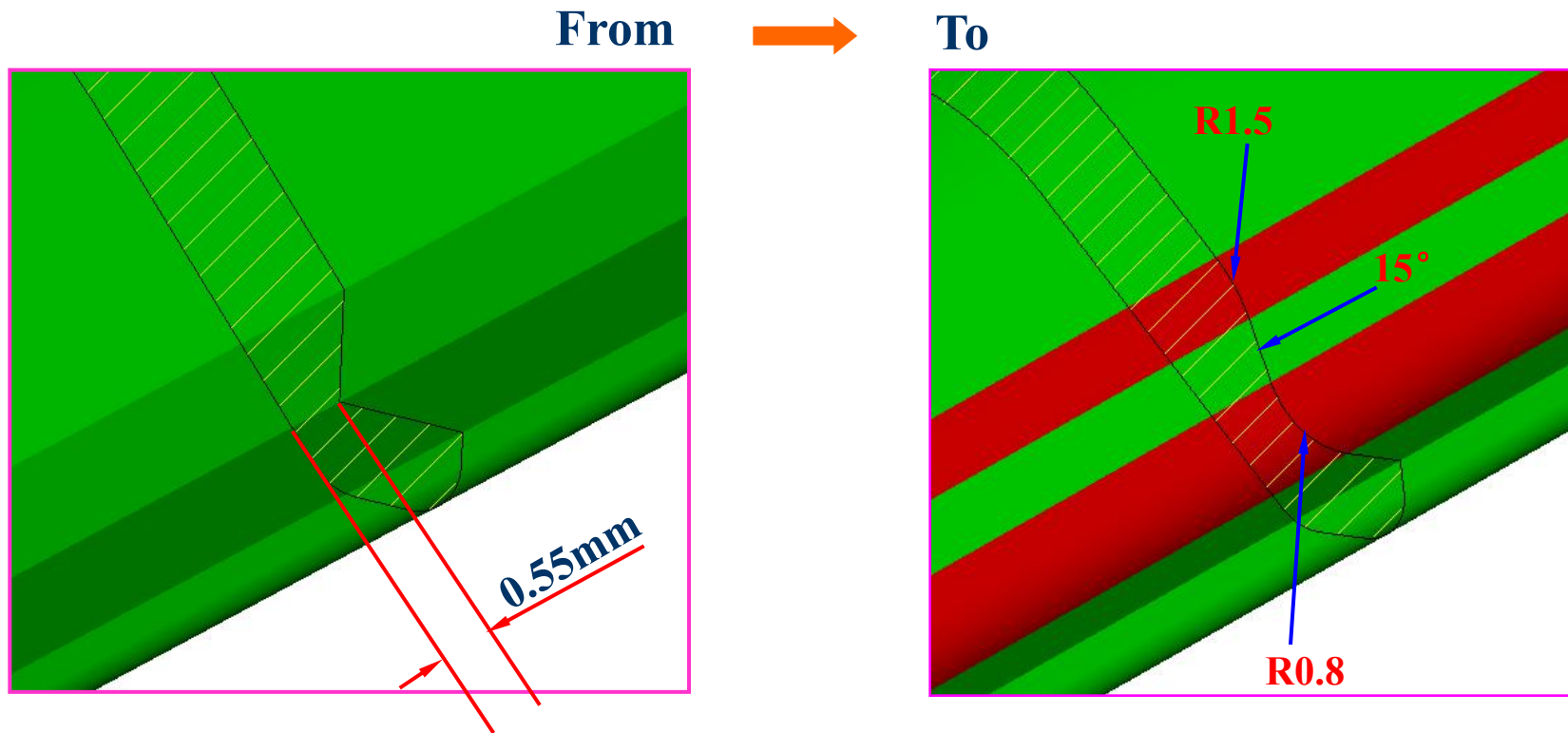

3.2.2肉厚问题-阴影

From



To

加斜面 (45°)

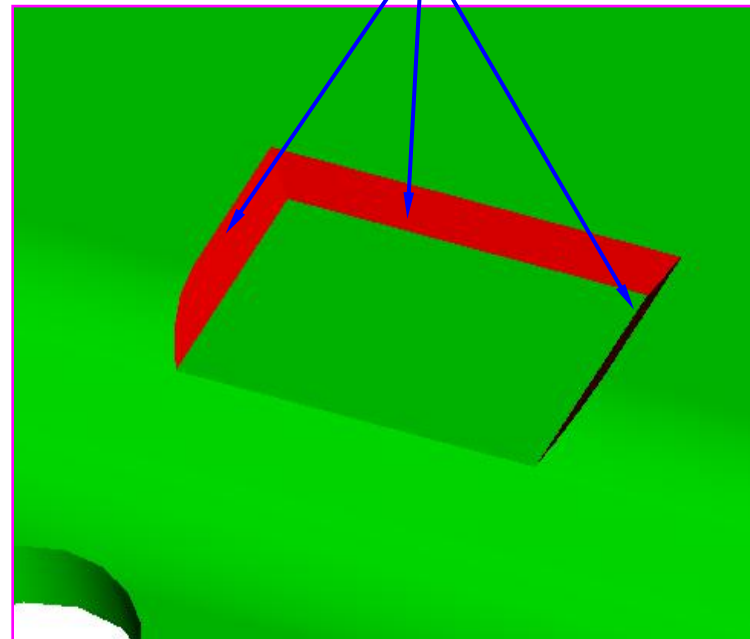
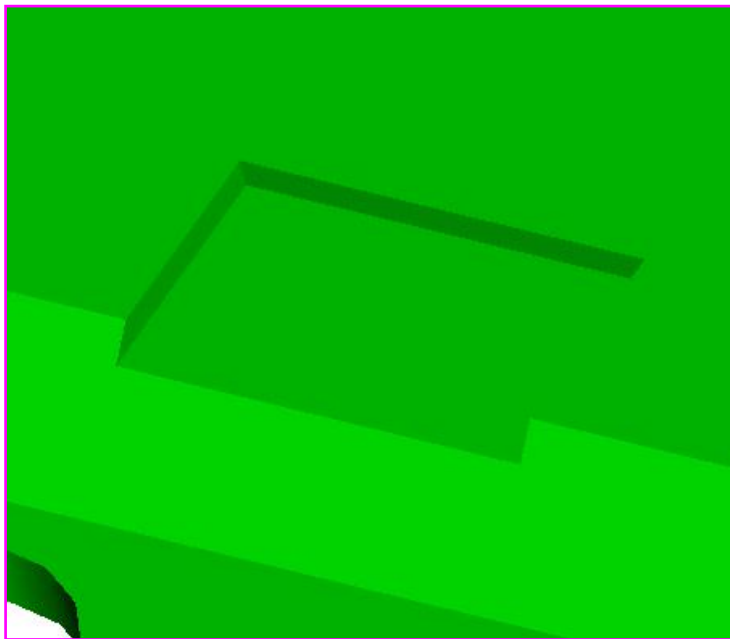

3.2.3肉厚问题-阴影

From  To

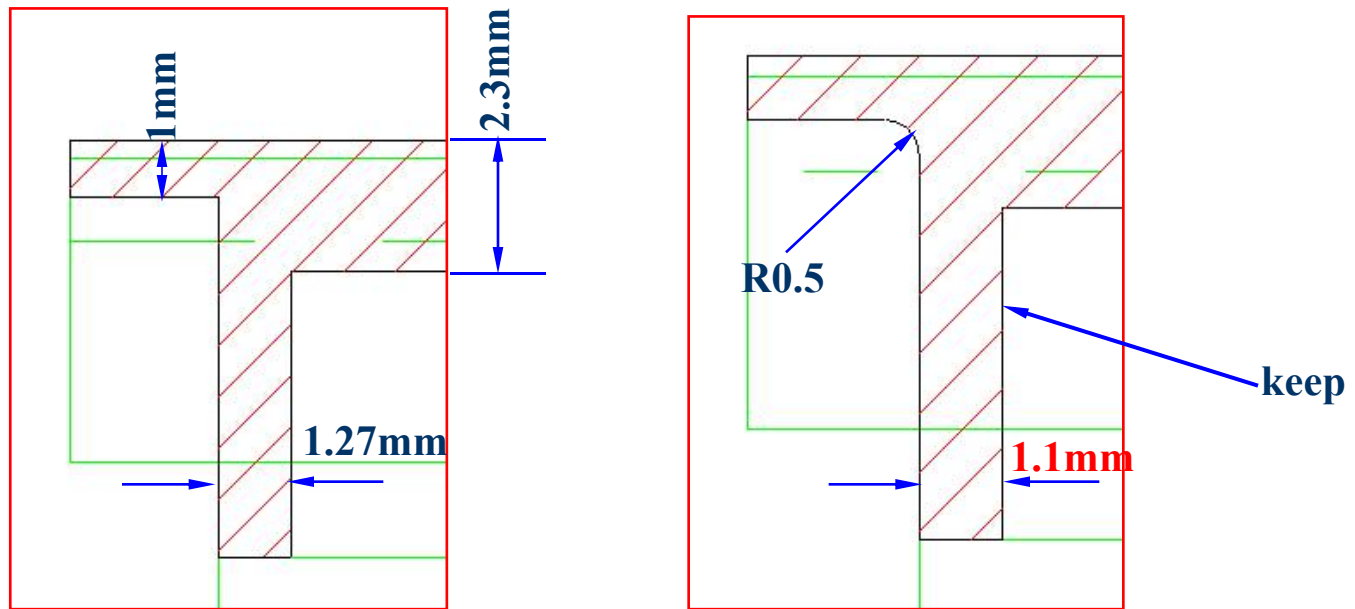

3.2.3肉厚问题-阴影

From → To

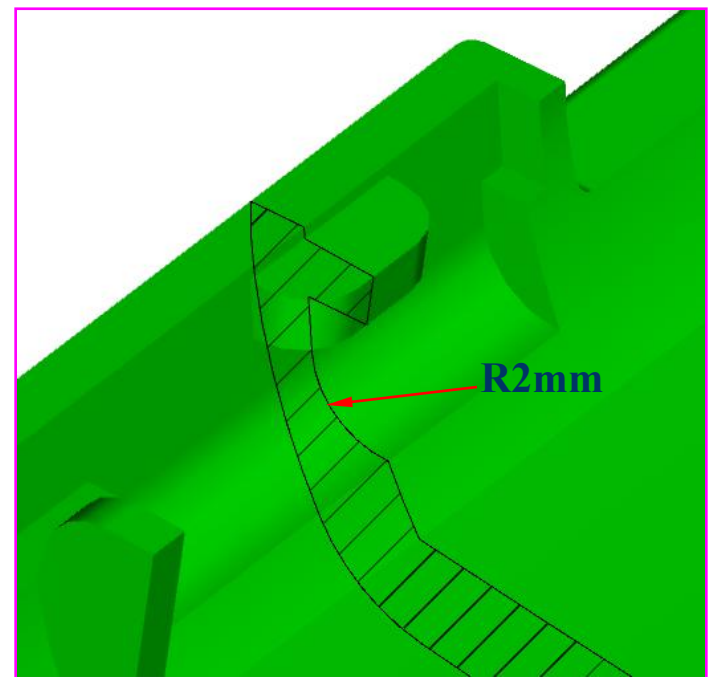
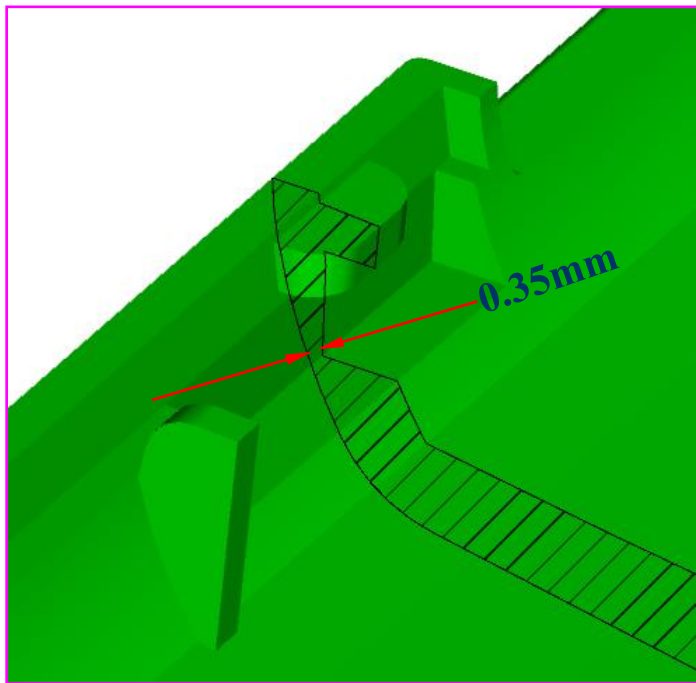

3.2.4肉厚问题-阴影

From  To

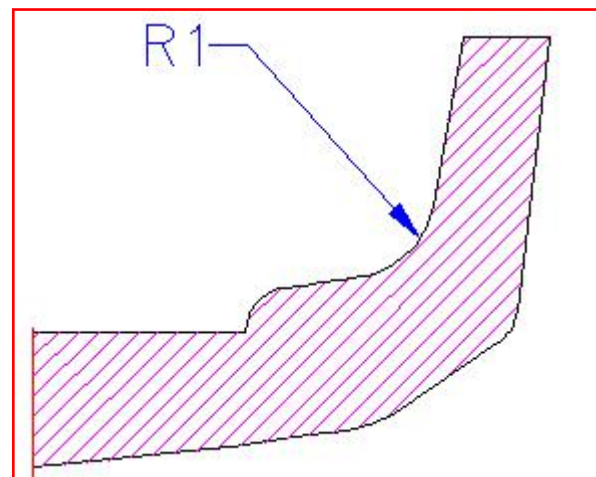
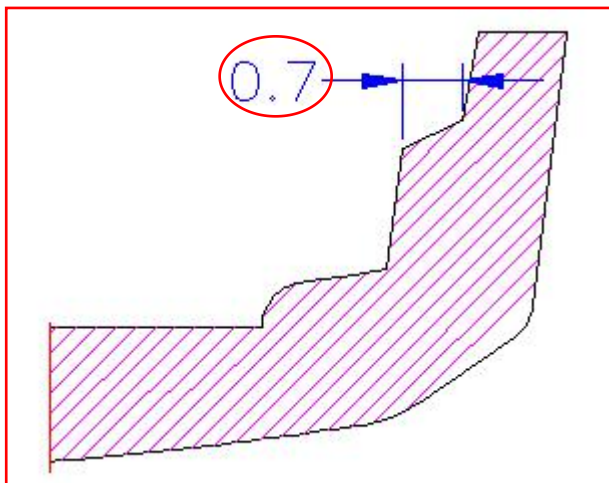

3.2.5肉厚问题-阴影

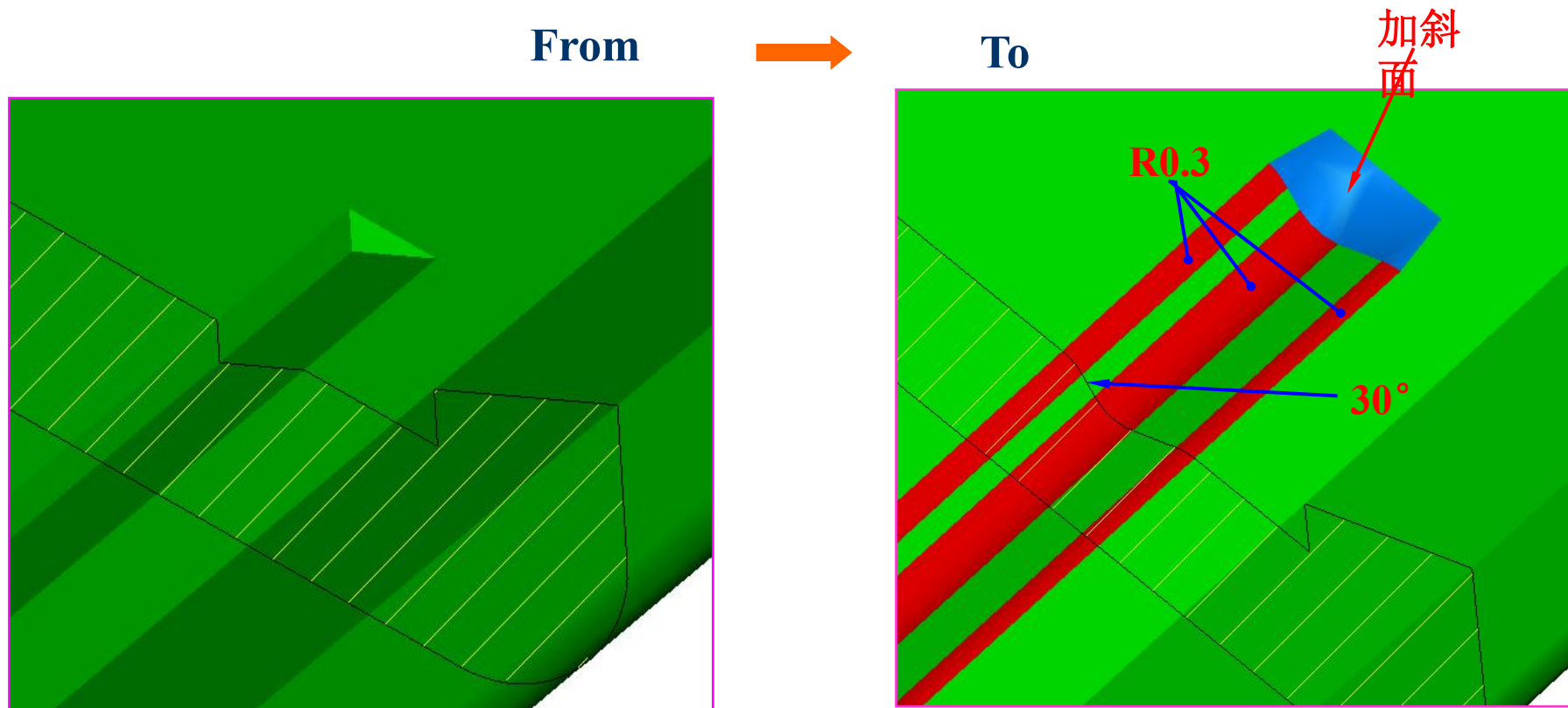

3.3.1 肉厚问题-尖角

From



to

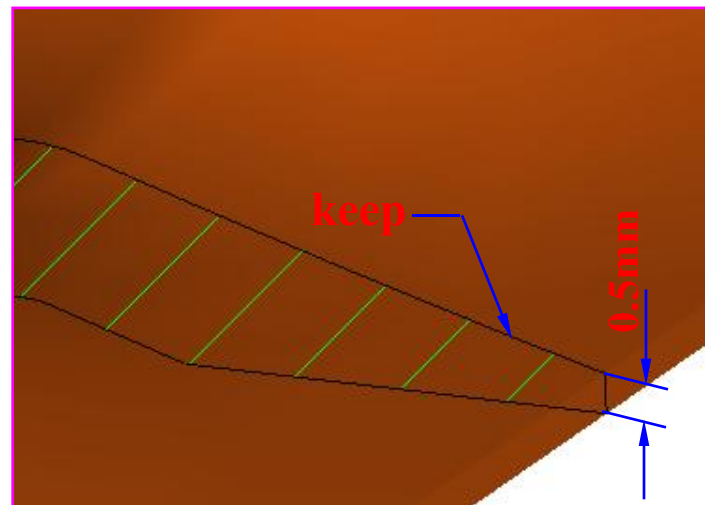
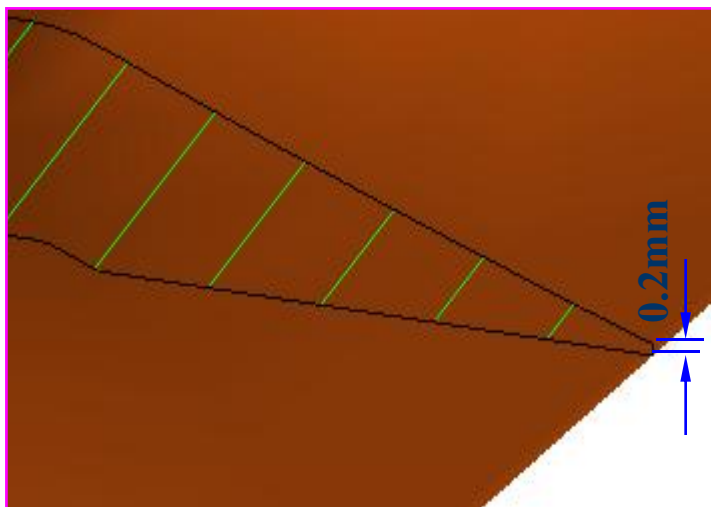

3.3.2肉厚问题-尖角

From  To

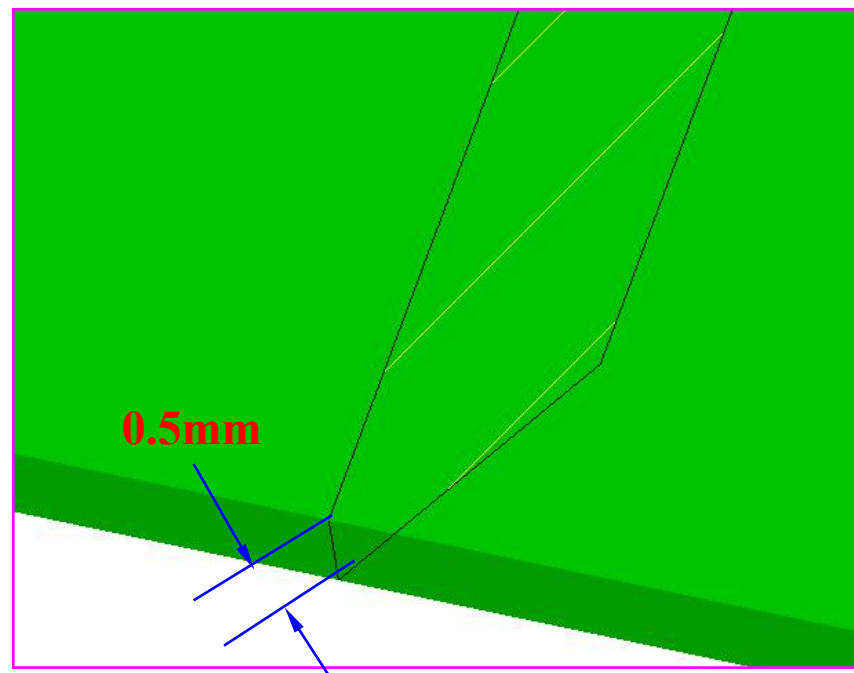
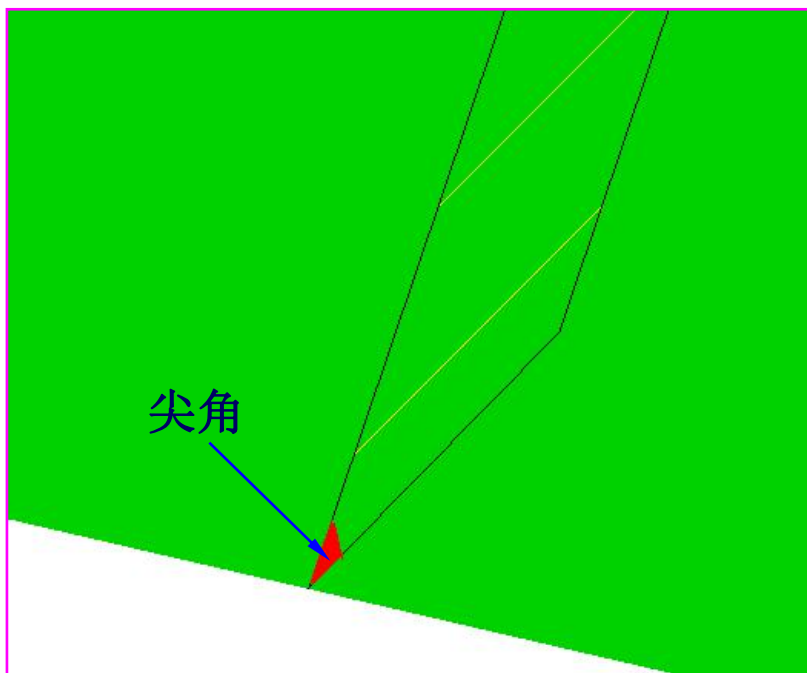

3.3.3肉厚问题-尖角

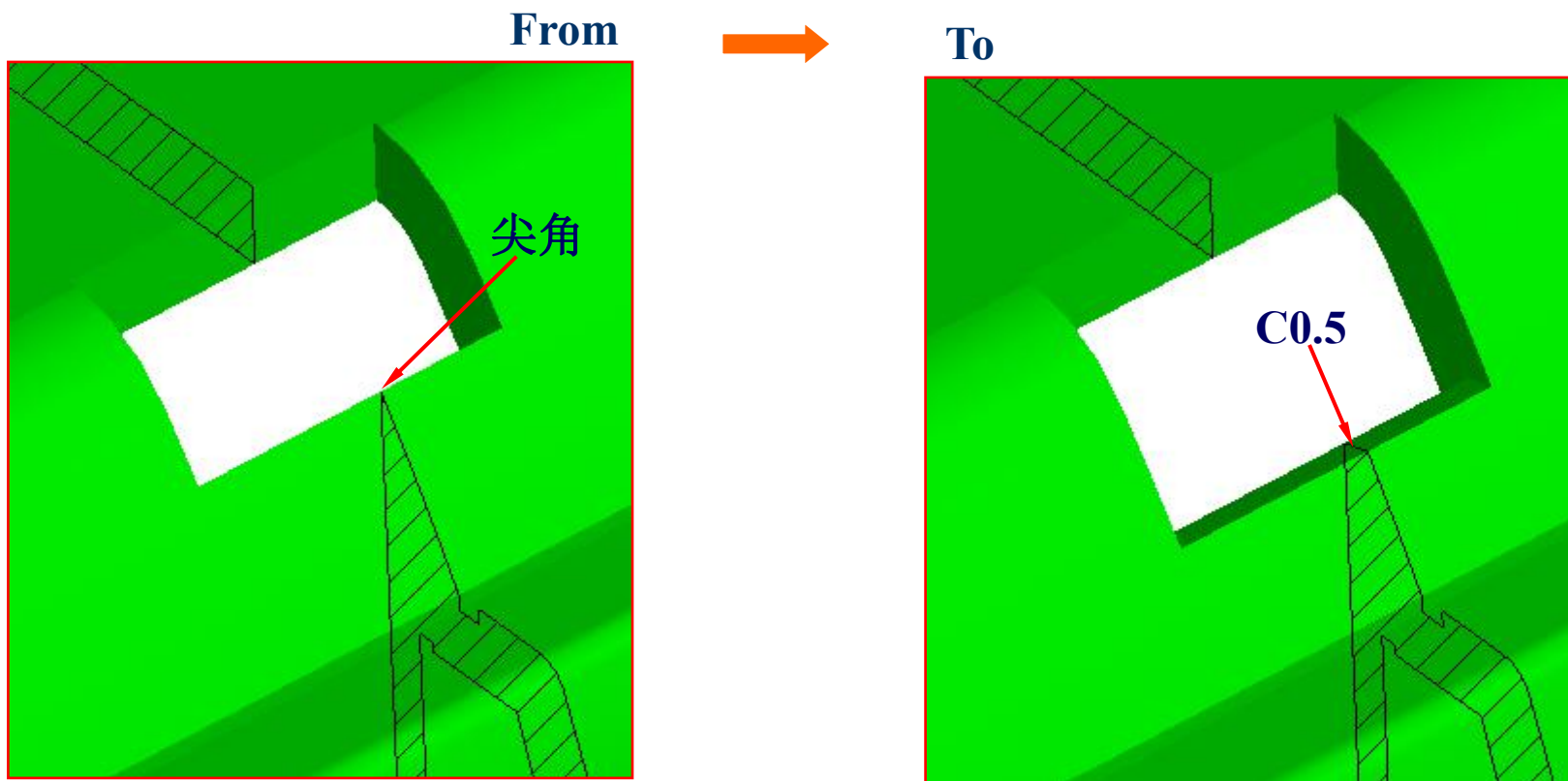

3.4.1 肉厚问题-薄壁

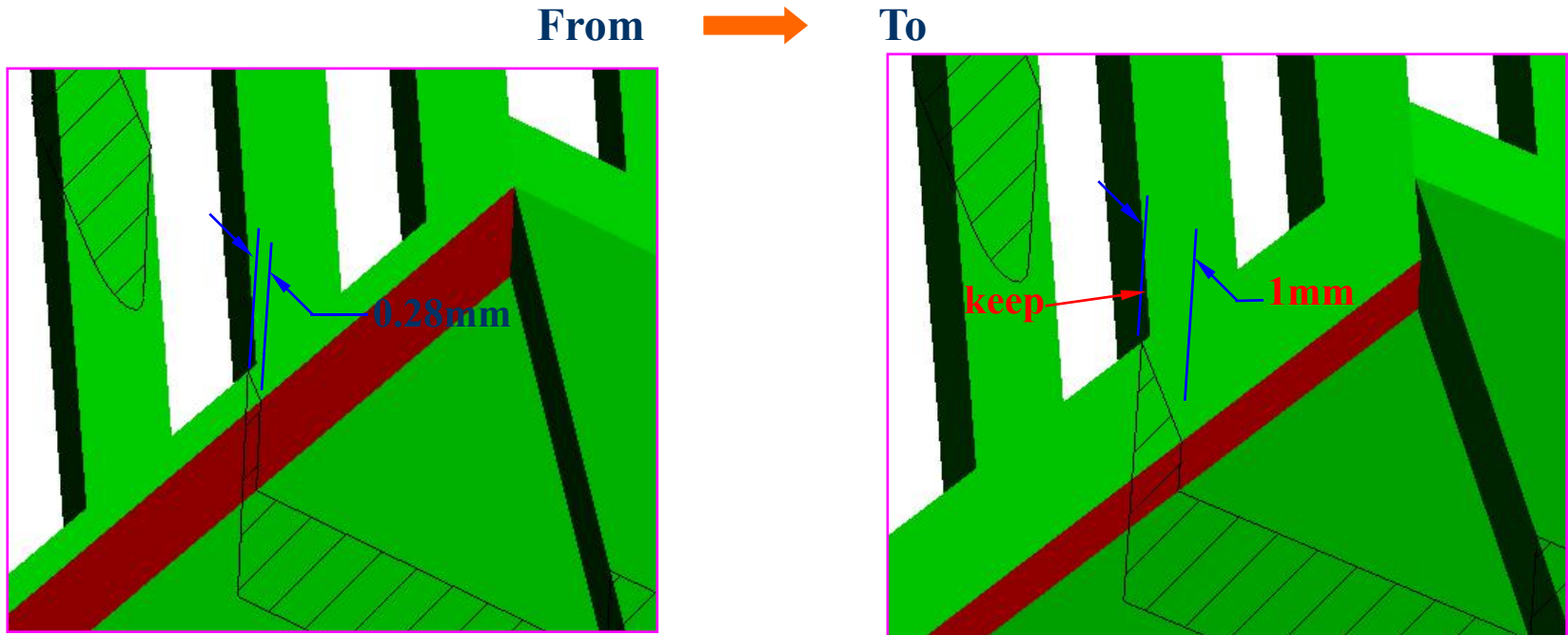

4.1 顶出问题-透明件

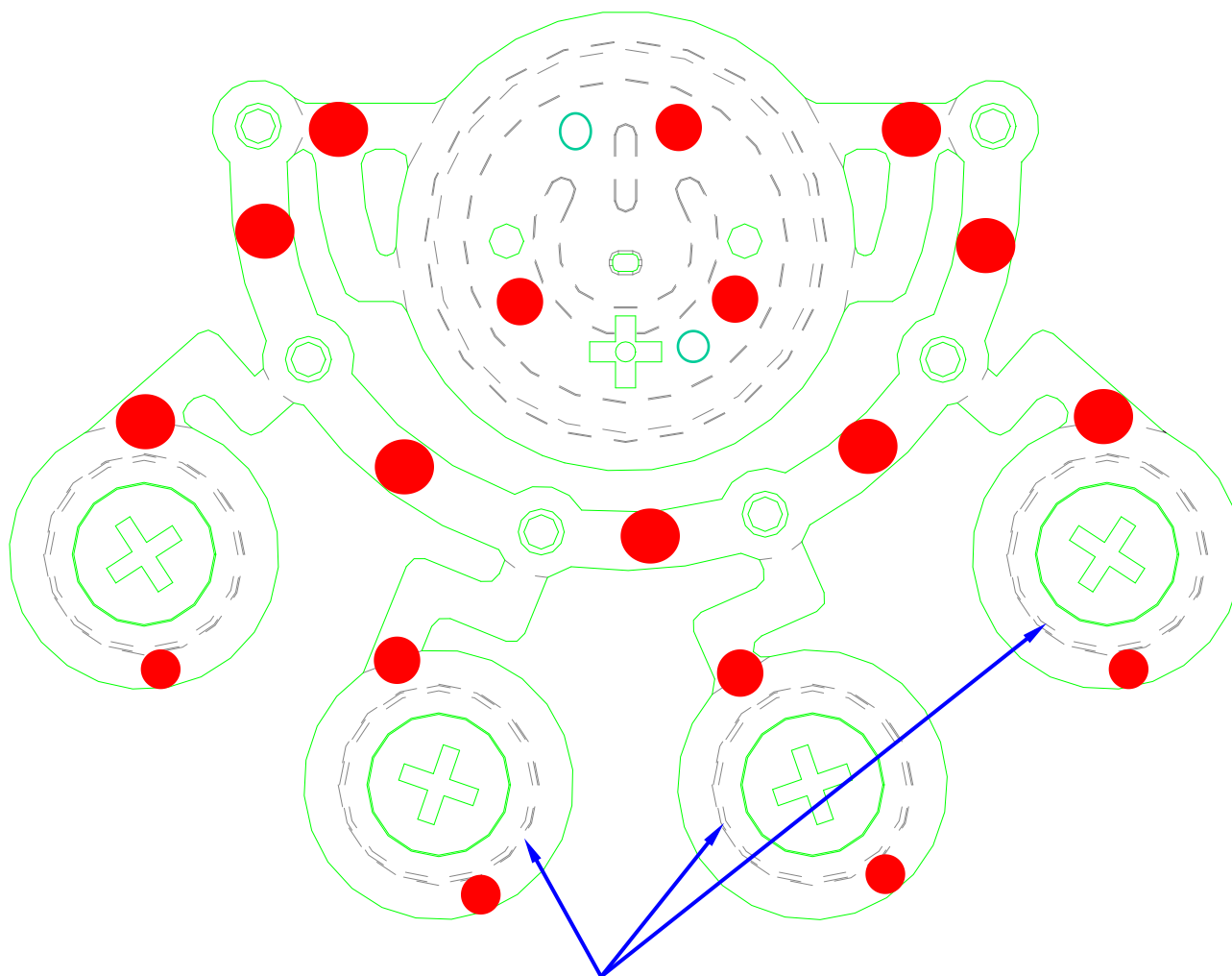

对透明件而言，必须确认顶针位置是否会影响产品的导光或者其他要求。

4.2 顶出问题 - BOSS

From → To

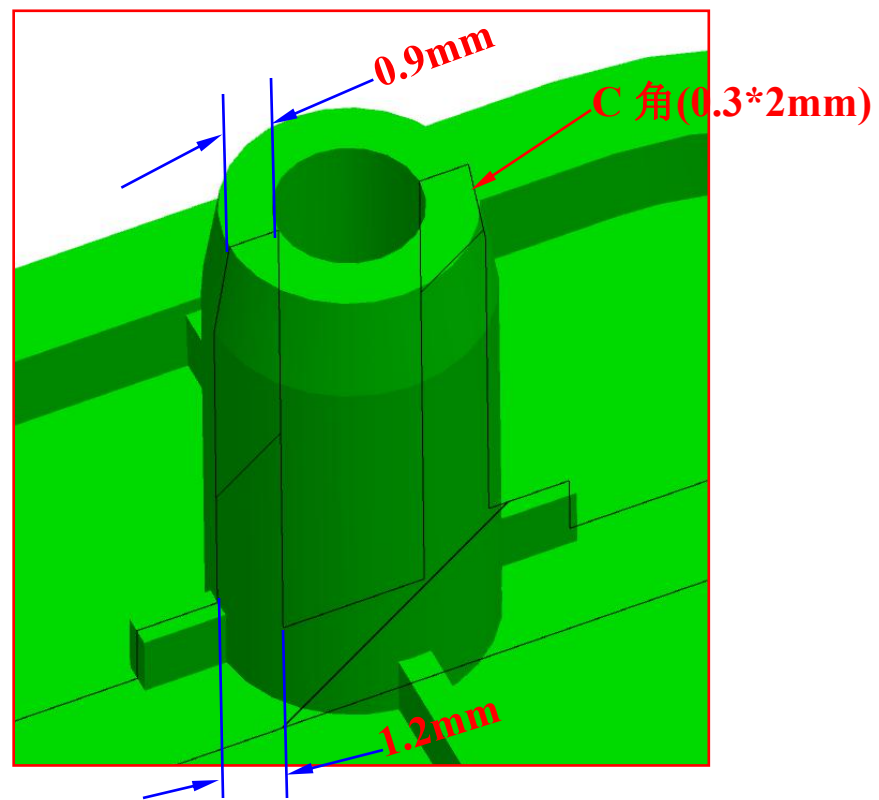
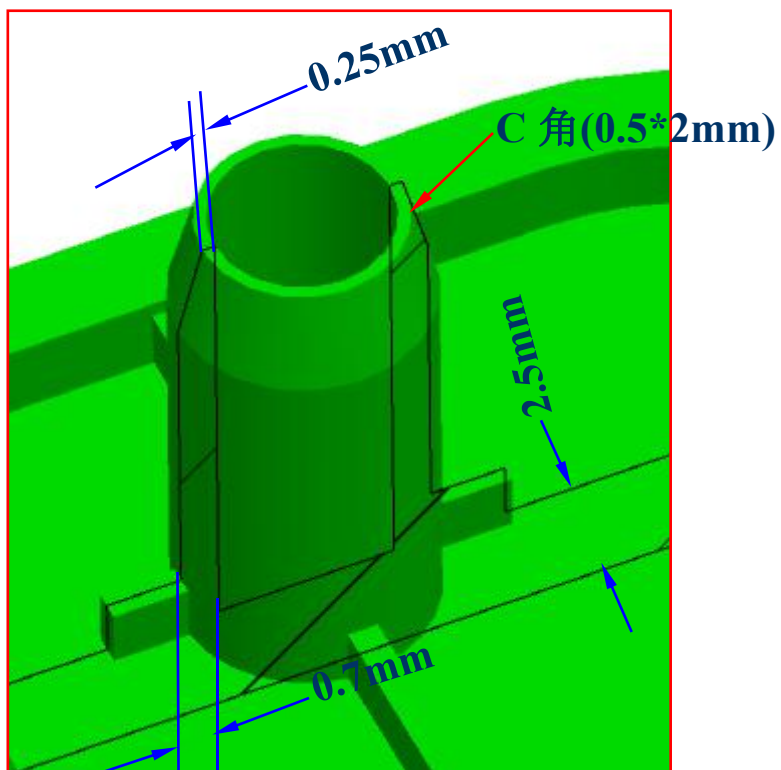

5.1.1加工问题-加工极限

From → To

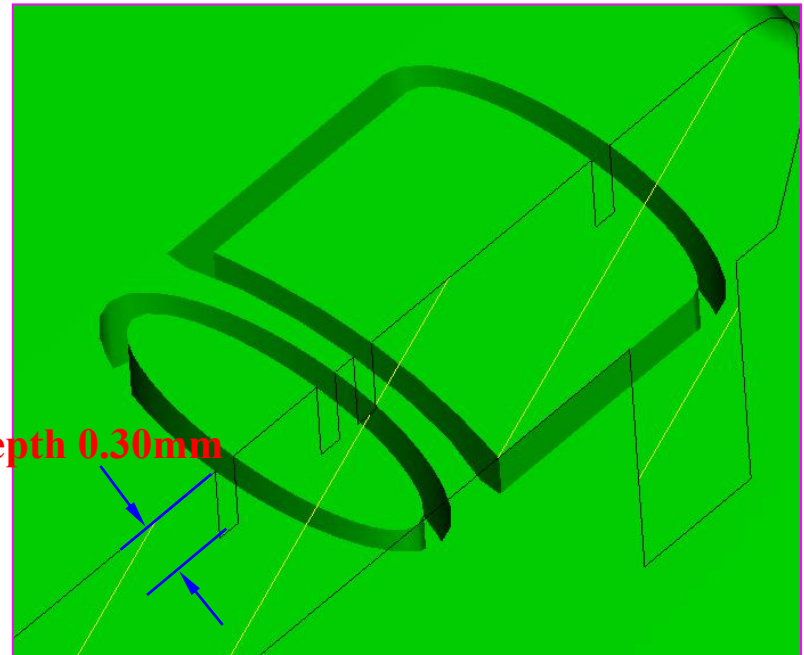
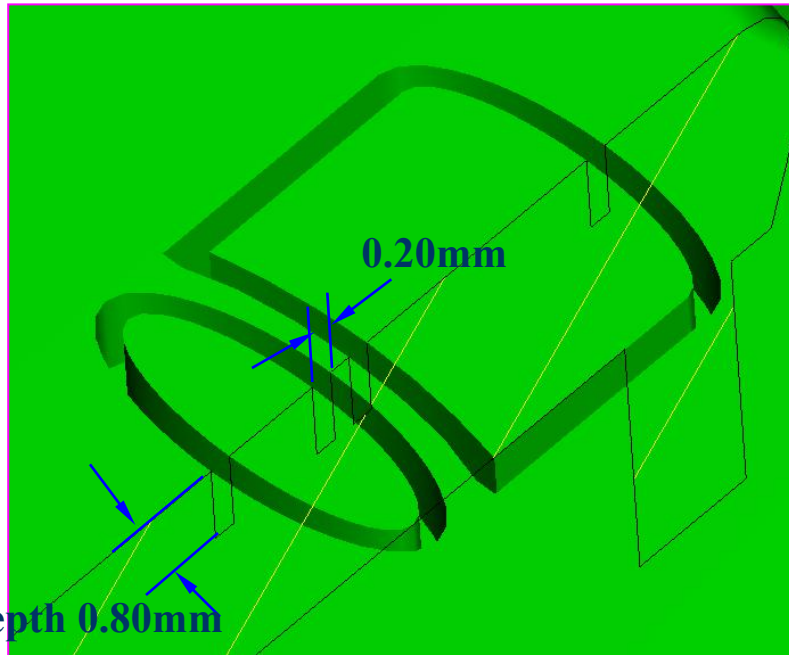

5.2.1加工问题-公模R角

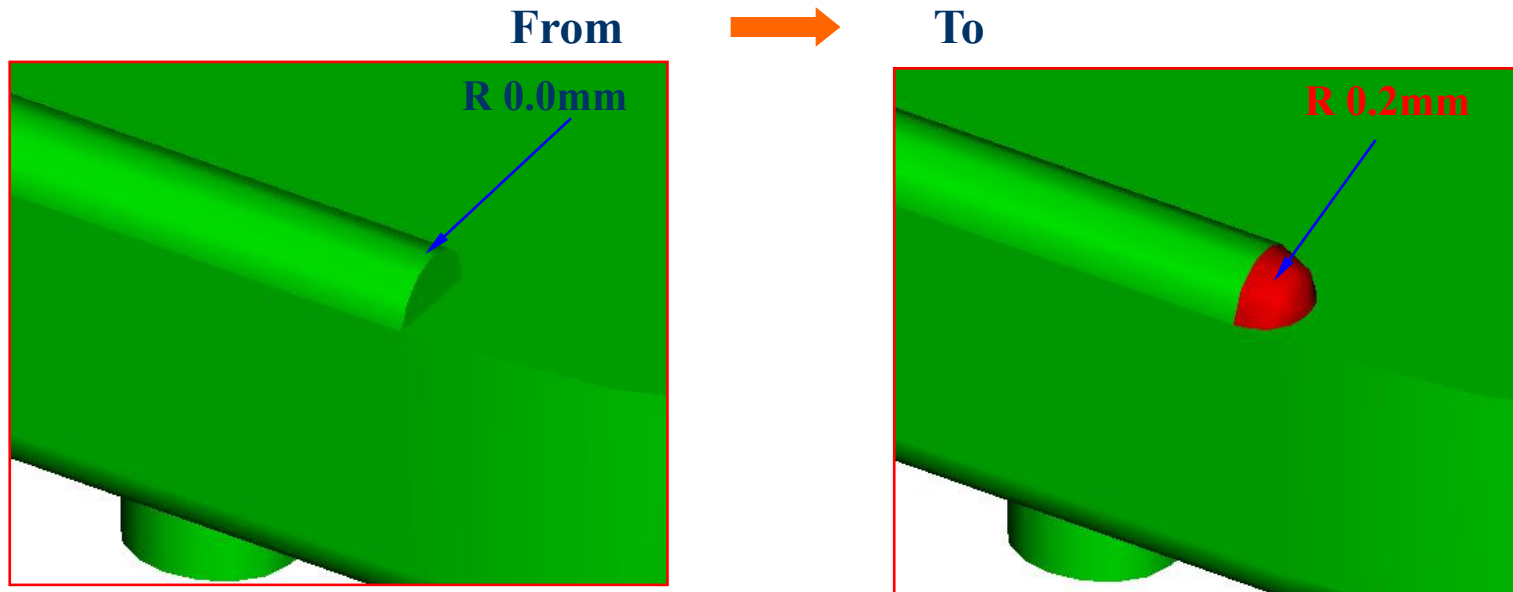

5.2.2加工问题-公模R角

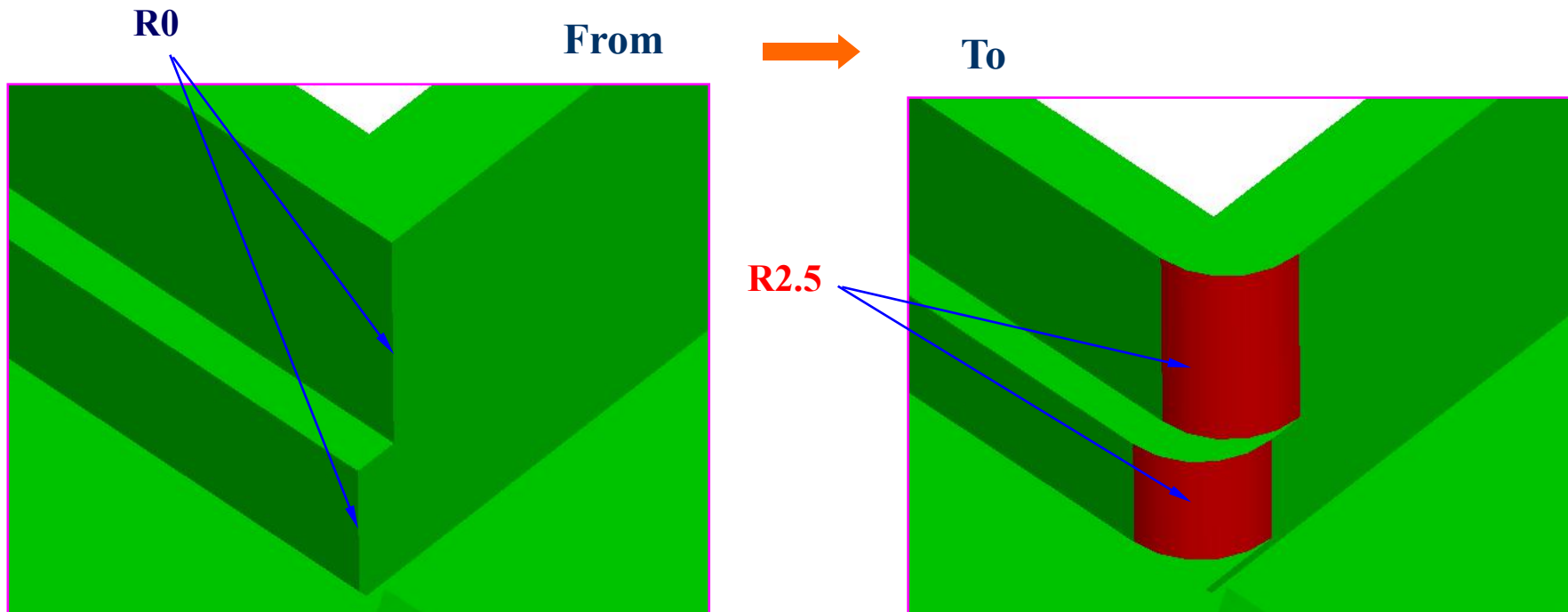

5.2.3加工问题-公模R角

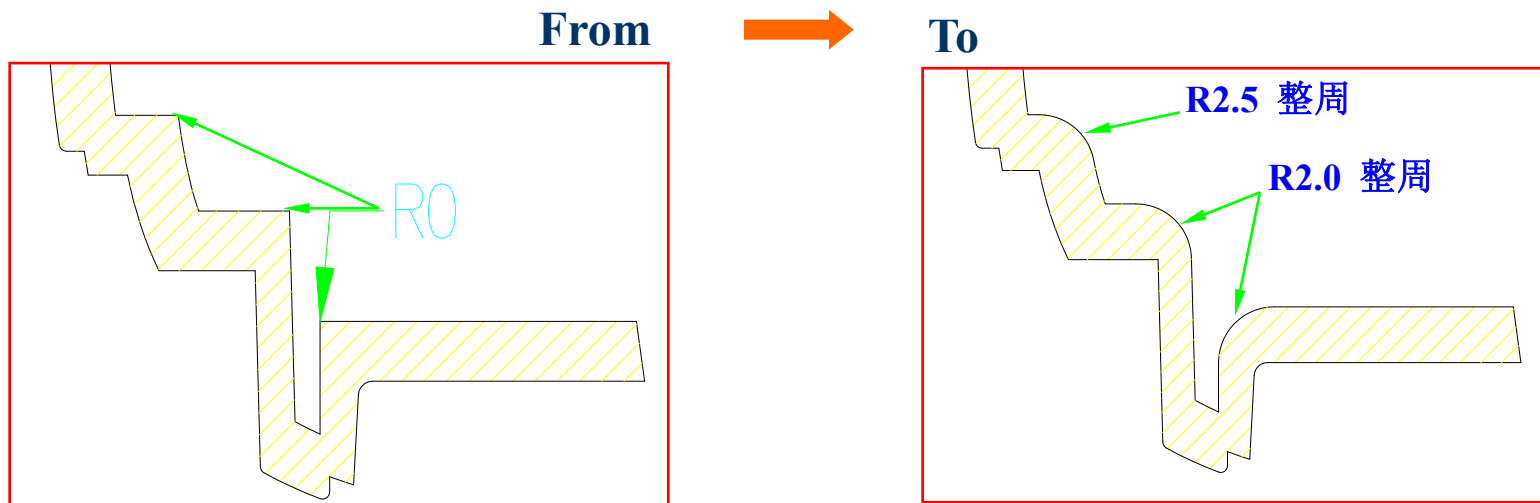

6.1.1强度问题-模仁类

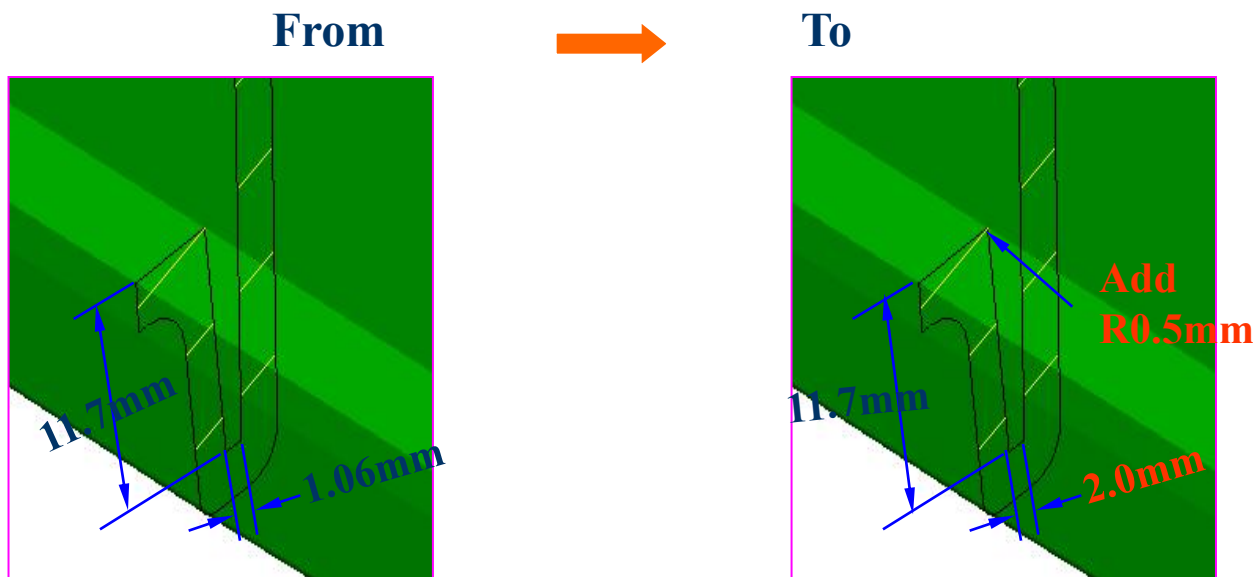

6.1.2 强度问题-模仁类

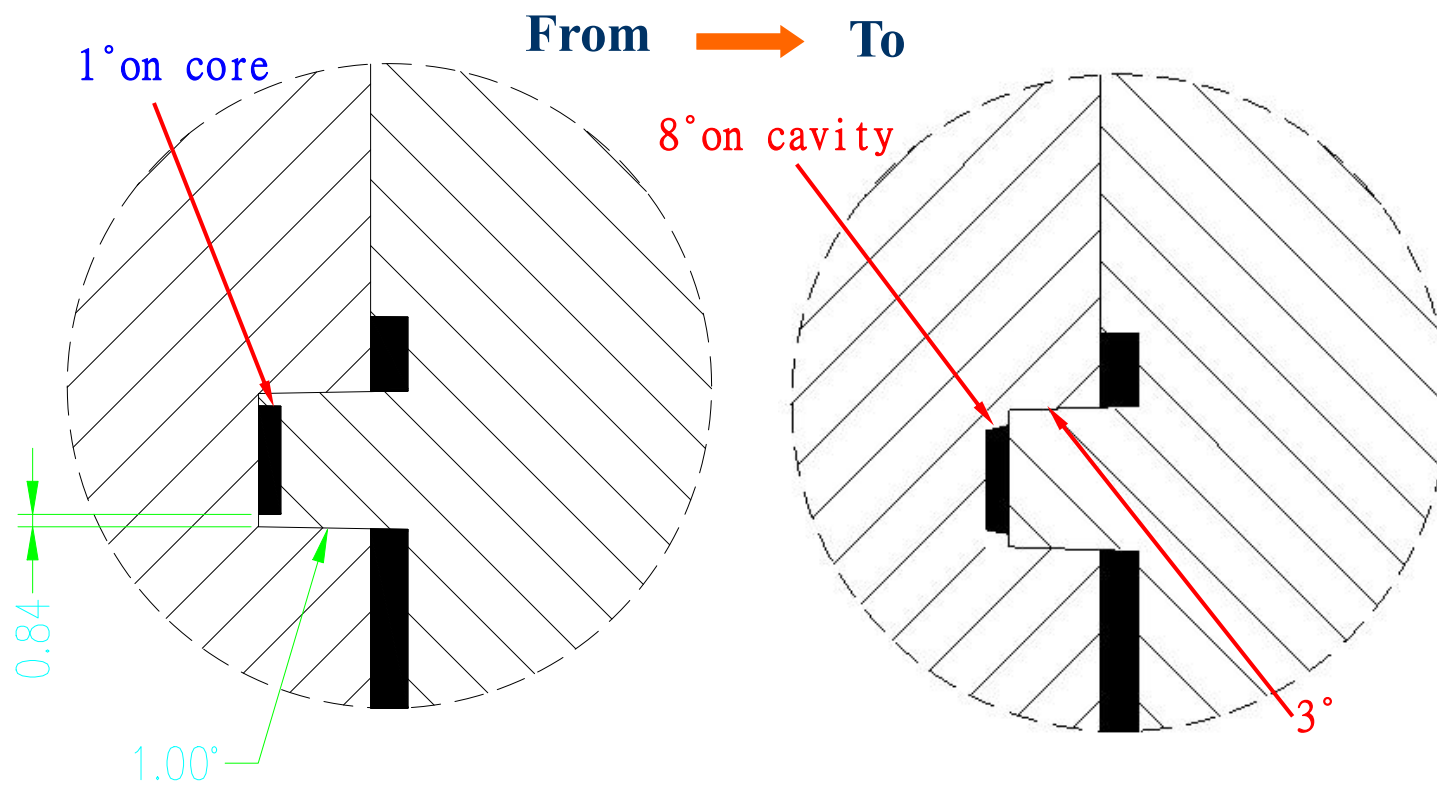
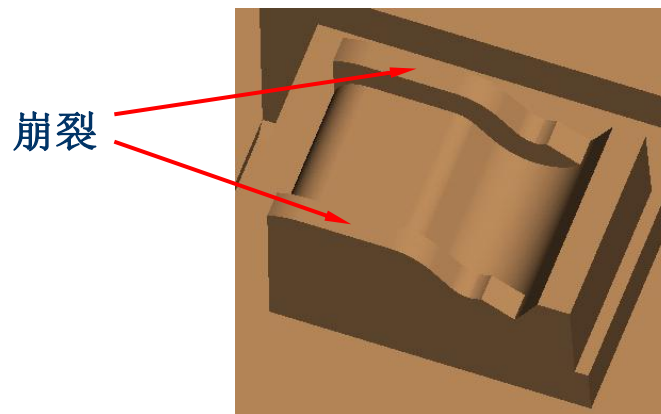

6.2强度问题-斜销类

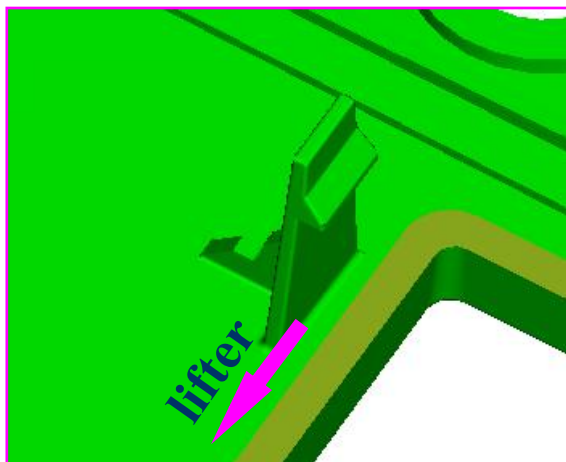

改善方案:向外侧加宽 8mm

From



To

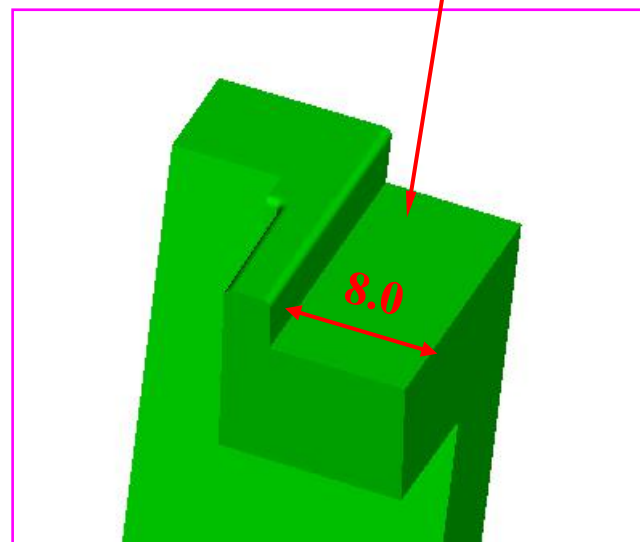
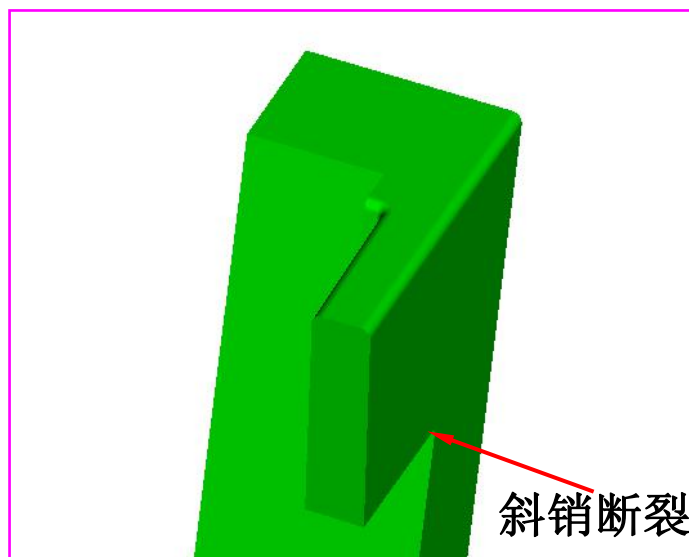

7.1 R角问题-倒勾取消

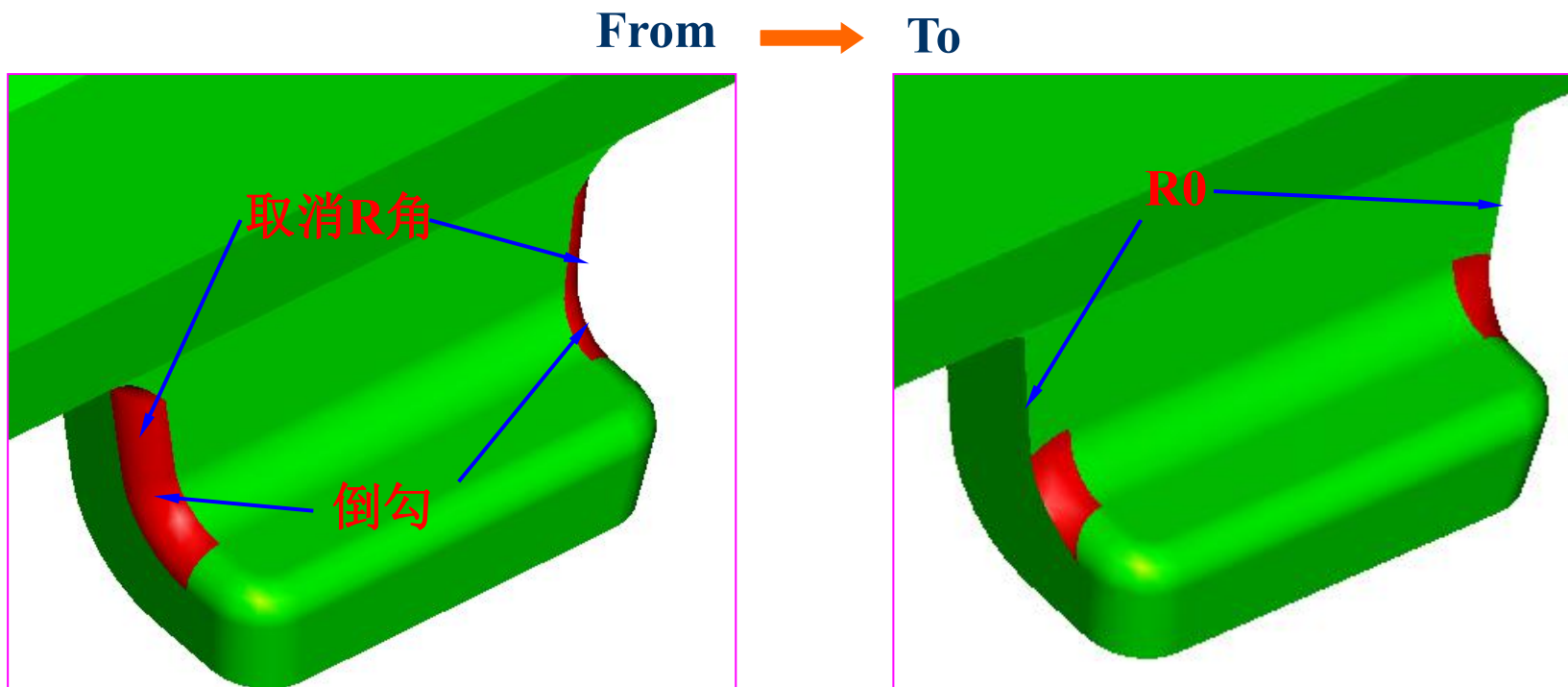

8.1 咬花问题-深肋

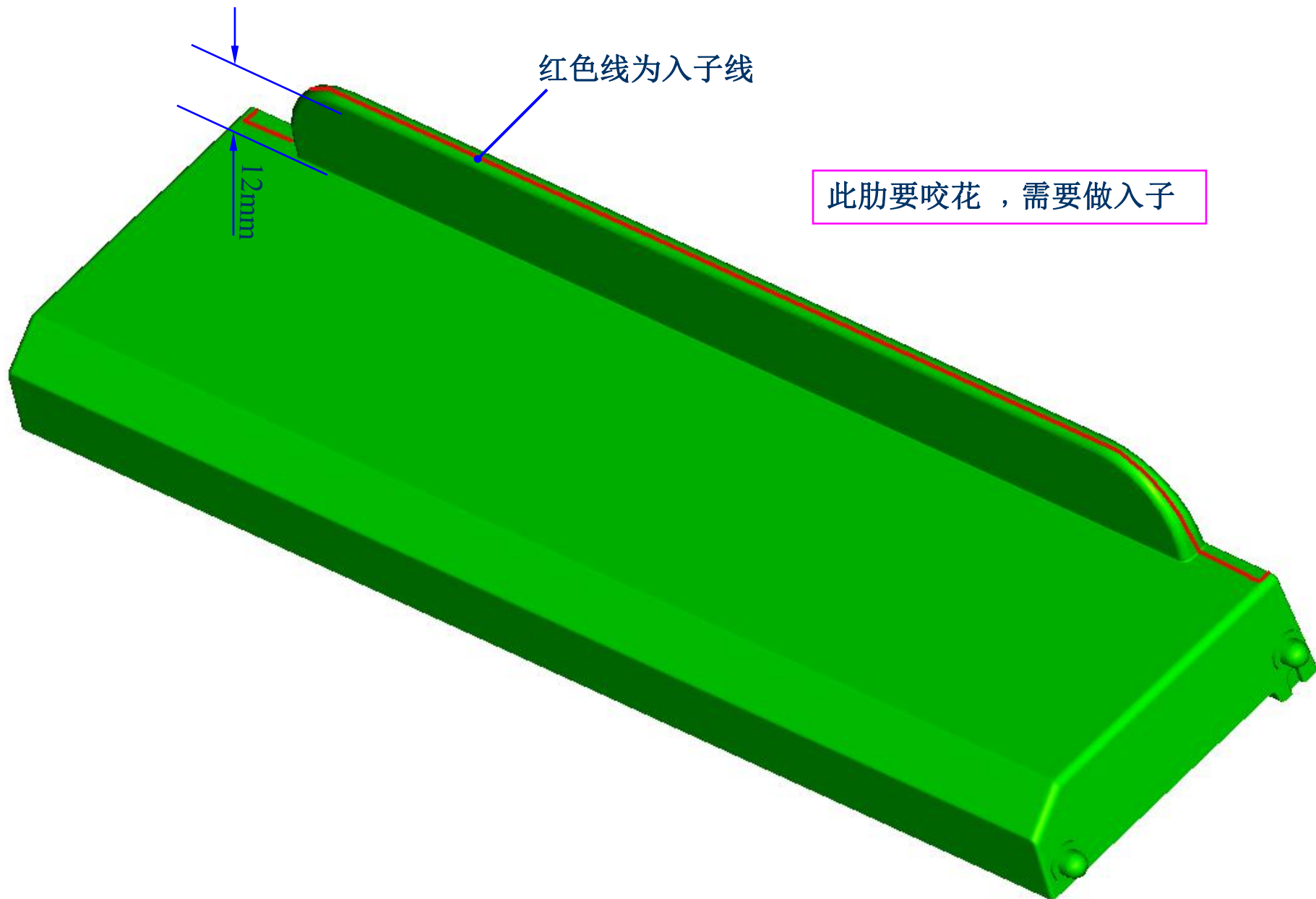

9.1 拋光問題-透明件

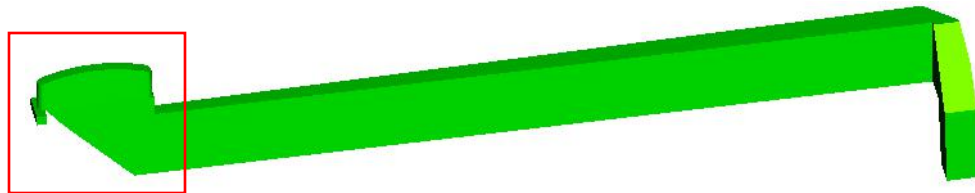

此件為透明導光件，需要做入子拋光，入子線如圖示：

紅色線為入子線

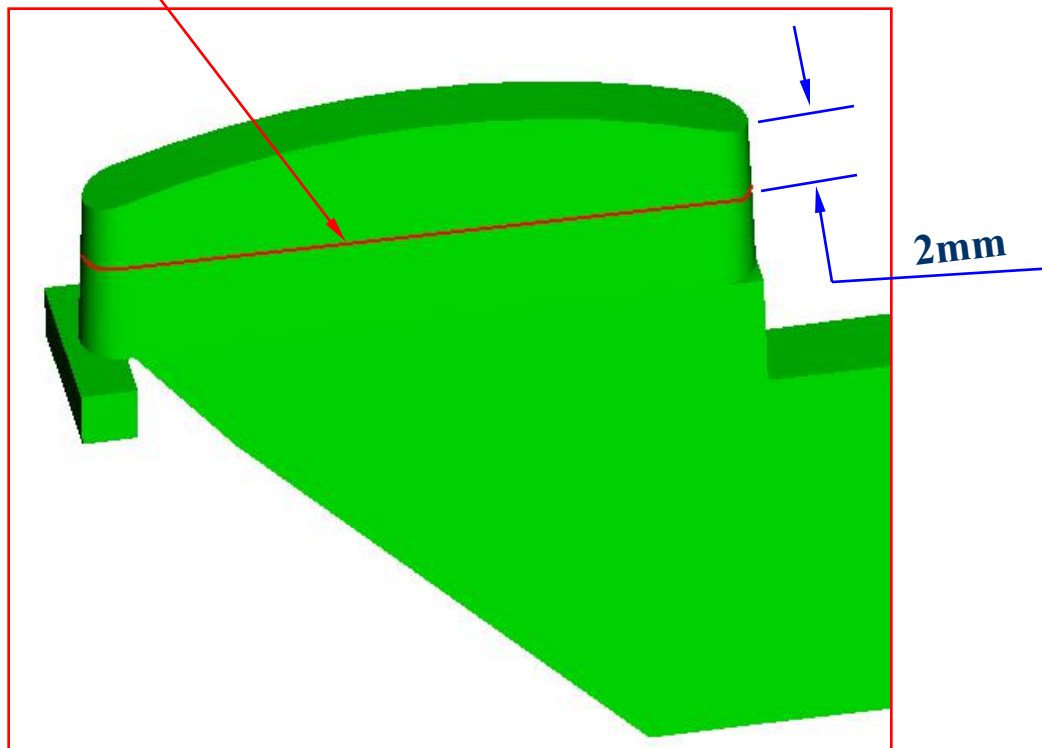

10.1 变形问题 - 增加肋

增加肋以减少产品变形量。

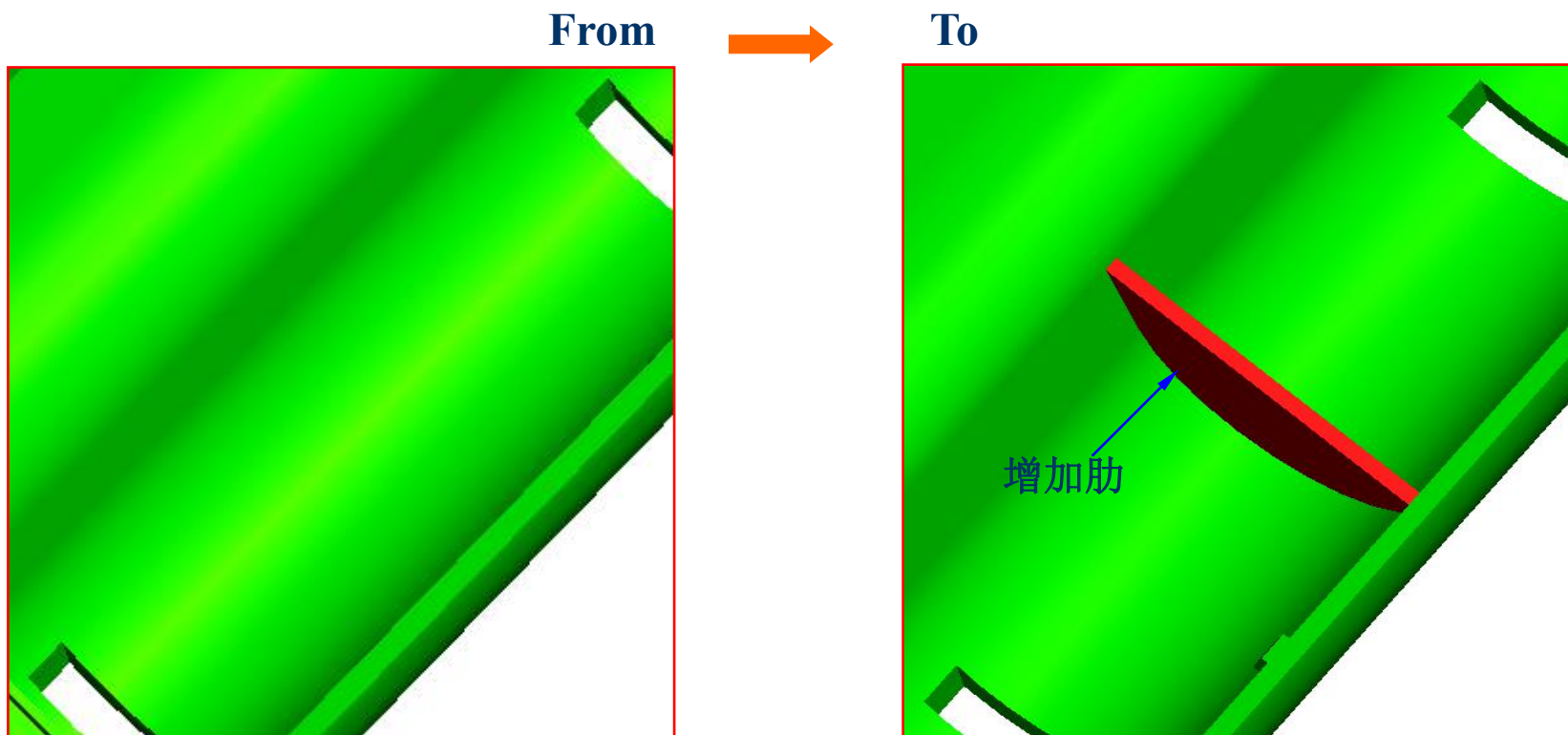

10.2变形问题-浇口形式更改

